

PELLET FIREPLACE

## PELLKAMIN 12 EVO



with drawer



with hatch

The original language of this manual is Italian

The undersigned EDILKAMIN S.p.A., with registered office in Via P. Moscati - 20154 Milan (Italy) - Tax ID Code and code and VAT number 00192220192

Hereby declares, under its sole responsibility, that:  
The product mentioned below complies with EU Regulation 305/2011 and the harmonised EU standard EN 14785:2006

PELLET FIREPLACE, bearing the  
EDILKAMIN brand, known as PELLKAMIN 12 EVO

SERIAL NO.: Rating plate reference  
Performance declaration: (DoP - EK no. 202a): Rating plate reference

Moreover, the company hereby declares that:  
PELLKAMIN 12 EVO complies with the requirements in the following European Directives:  
2014/35/EC - Low Voltage Directive  
2014/30/EC - Electromagnetic Compatibility Directive

Dear Sir/Madam,  
Congratulations on choosing our product. Before you use it, please read this manual carefully, to get the best from your new appliance in total safety.

This manual is an integral part of the product. We would ask you to keep it for the entire lifetime of the product. If you lose it, you can request a copy from your dealer or download it from [www.edilkamin.com](http://www.edilkamin.com)

After unpacking the product, check the condition and completeness of the contents.

If you find any anomalies, immediately contact the dealer where the purchase was made, providing them with a copy of the warranty certificate and the sales receipt.

The appliance must be correctly sized, installed, maintained and operated in compliance with local and national law and with European regulations. For the installation process, and for anything not specifically indicated in the manual, the local regulations apply. The diagrams provided in this manual are for illustration purposes only: they do not always strictly refer to your specific model, and are not binding in any way.

The product is uniquely identified by a number, the "counterfoil", which is on the warranty certificate.

Please keep:

- the warranty certificate accompanying the product;
- the sales receipt given to you by the dealer;
- the declaration of conformity given to you by the installer.

The warranty conditions are given in the warranty certificate accompanying the product and on the website [www.edilkamin.com](http://www.edilkamin.com).

The warranty, however, covers only demonstrable manufacturing defects and not, for instance, problems resulting from improper installation or calibration.

**The CE plate is on the left side, as you remove the product, AFTER BEING SWITCHED OFF AND ANCHORED TO THE BASE.**  
**The procedures for removing the product are described in this manual.**

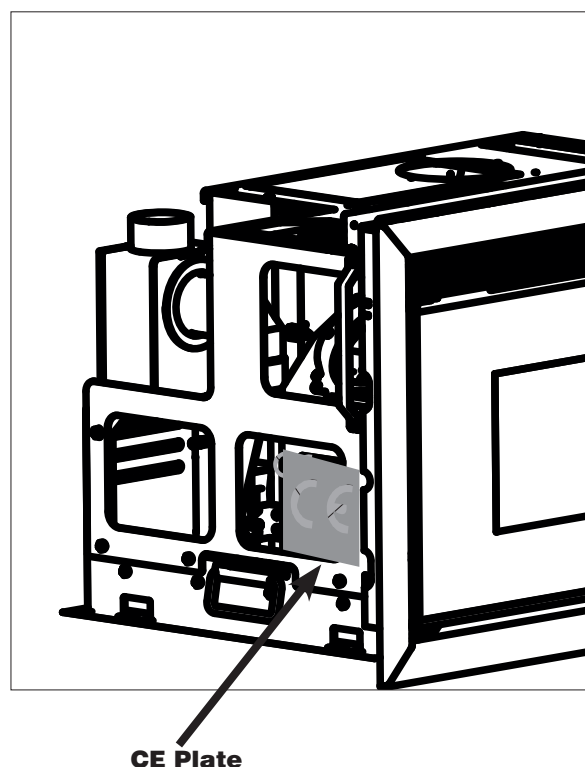

### MEANING OF SYMBOLS

In some parts of the manual the following symbols are used:



#### PLEASE NOTE:

carefully read and understand the message in question, since failure to follow the instructions in it could cause serious damage to the product and put the safety of those using it at risk.



#### INFORMATION:

failure to comply with these requirements will compromise product use.



#### OPERATING SEQUENCE:

follow the instructions for the operations described

- The appliance is not designed for use by people, including children, with limited physical, sensory and mental capacities.
- The appliance is not designed for cooking purposes.
- The appliance is designed to burn UNI EN ISO 17225-2 category A1 wood pellets, in the amounts and manner described in this manual.
- The appliance is designed for indoor use and in areas with normal humidity conditions.
- Keep the product in a dry place out of the weather.

Safety risks may be caused by:

- installation in unsuitable conditions. In particular, conditions of fire hazard. **DO NOT INSTALL THE APPLIANCE IN AREAS WHERE THERE IS A RISK OF FIRE.**
- contact with fire and hot parts (e.g. glass panel and pipes). **DO NOT TOUCH HOT PARTS** and, when the stove is switched off and still hot, always wear the glove.
- contact with live electrical equipment (internal). **DO NOT ACCESS THE INTERNAL ELECTRICAL EQUIPMENT WHILE THE APPLIANCE IS POWERED ON.** Electrocution hazard.
- use of improper ignition aids (e.g. alcohol). **DO NOT IGNITE OR BOOST THE FLAME WITH FLUID SPRAYS OR A FLAME TORCH.** Serious risk of burns, damage and injury.
- use of fuel other than wood pellets. **DO NOT BURN WASTE MATTER, PLASTIC OR MATERIALS OTHER THAN WOOD PELLETS IN THE COMBUSTION CHAMBER.** The product may become soiled, the flue may catch fire, and environmental damage may ensue.
- cleaning of the combustion chamber when hot. **DO NOT CLEAN THE COMBUSTION CHAMBER WITH A VACUUM CLEANER WHILE IT IS HOT.** You could damage the vacuum-cleaner and risk the emission of smoke into the room.
- Cleaning the smoke duct with cleaning products. **DO NOT CLEAN THE PRODUCT WITH FLAMMABLE PRODUCTS.** Risk of fire or blowback.

- Cleaning the hot glass panel with unsuitable products. **DO NOT CLEAN HOT GLASS WITH WATER. ONLY USE RECOMMENDED GLASS CLEANING PRODUCTS.** There is a risk of cracking and permanent irreparable damage to the glass.
- storage of flammable materials at a distance below the safety distances specified in this manual. **DO NOT PLACE LAUNDRY ON THE APPLIANCE. DO NOT PLACE DRYING RACKS WITHIN THE SAFETY CLEARANCE.** Keep flammable fluids away from the appliance. Fire hazard.
- blocking of the aeration vents and air intakes in the room. **DO NOT BLOCK THE AERATION VENTS OR THE FLUE.** This may cause smoke to return into the room resulting in damages to property and personal injury.
- Use of the product as a support or ladder. **DO NOT CLIMB ONTO THE PRODUCT OR USE IT AS A SUPPORT.** Risk of damage and injury.
- Use of the appliance with the combustion chamber open. **DO NOT USE THE APPLIANCE WITH ITS DOOR OPEN.**
- incandescent material projected following opening of the door. **DO NOT** throw incandescent material outside the appliance. Fire hazard.
- use of water in case of fire. **CALL THE AUTHORITIES** if a fire breaks out.

If you have any doubts, please do not take any action, but contact the dealer or the installer.

For reasons of safety, read the “user instructions” included in this manual.

The names of Edilkamin official authorised technical assistance centres (TAC) and distributors are available **ONLY** at [www.edilkamin.com](http://www.edilkamin.com)

**PELLKAMIN 12 EVO (cm)**

**IN ORDER TO LOAD THE PELLETS, YOU NEED TO PURCHASE EITHER A HATCH OR A TRAY KIT**

**- Hatch**

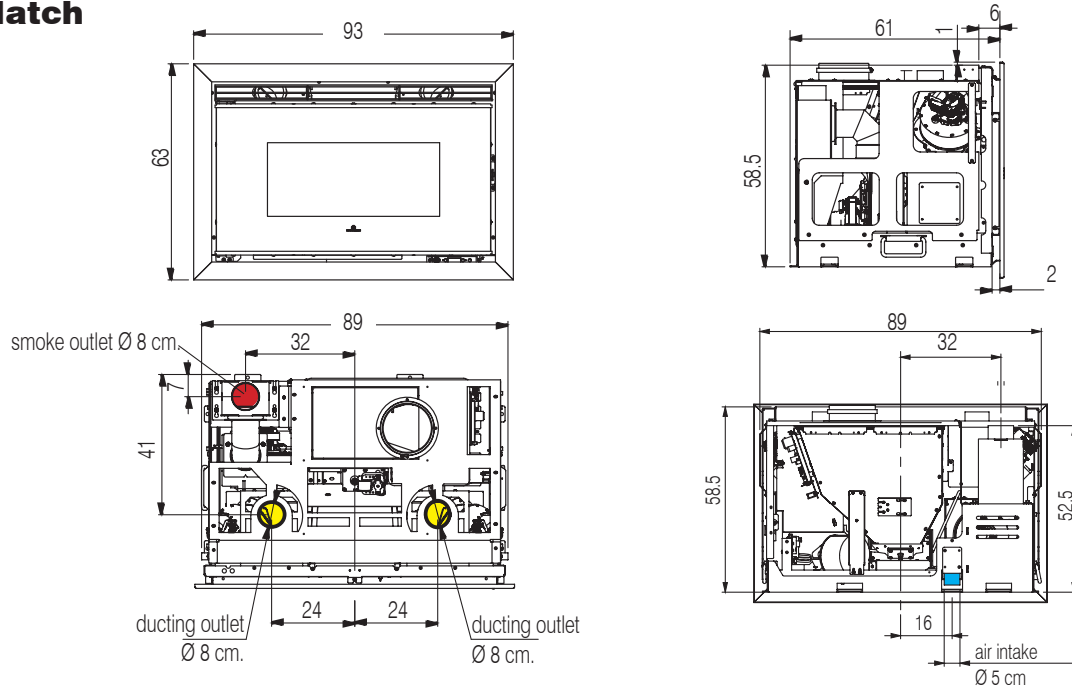

**- Tray**

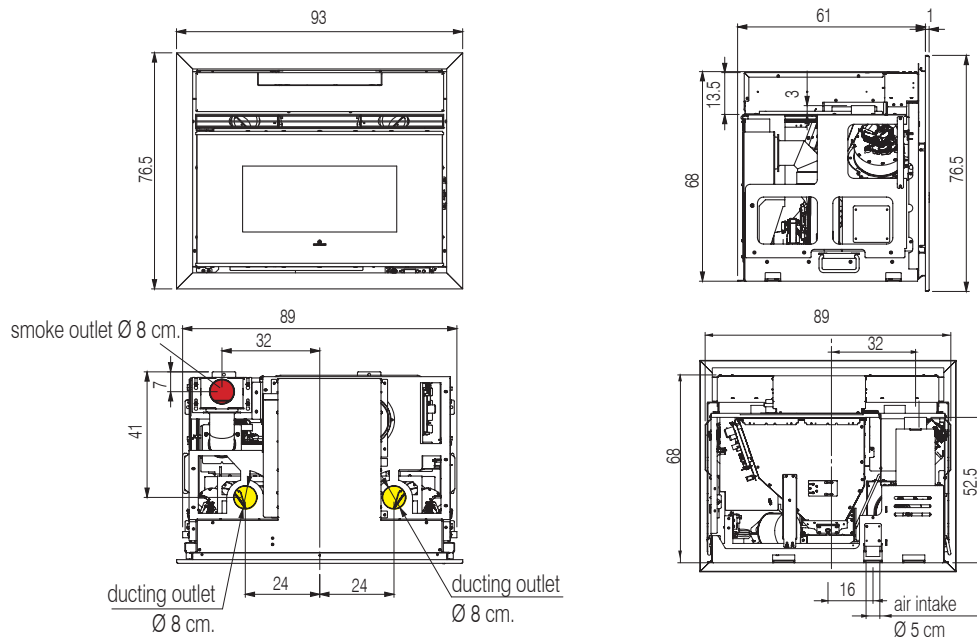

**NOTE:**

- The diameter of the smoke outlet is not the diameter of the flue system, which needs to be sized according to local and national regulations and in particular, but not limited thereto, EN 13384, EN 1443, EN 1856, EN 1457.
- The length of the ducting system and the temperature of the air leaving the air vent depend on the usage and installation conditions. We advise sizing the ducting system according to the load loss and using pipes that are smooth on the inside.

**Example of minimum recommended dimensions for installation with optional stand at minimum height. This example for illustrative purposes only.** Holes should also be made for: the smoke discharge (flue); the combustion air inlet; ventilation air recovery (a 10x10 cm hole in the side of the covering)

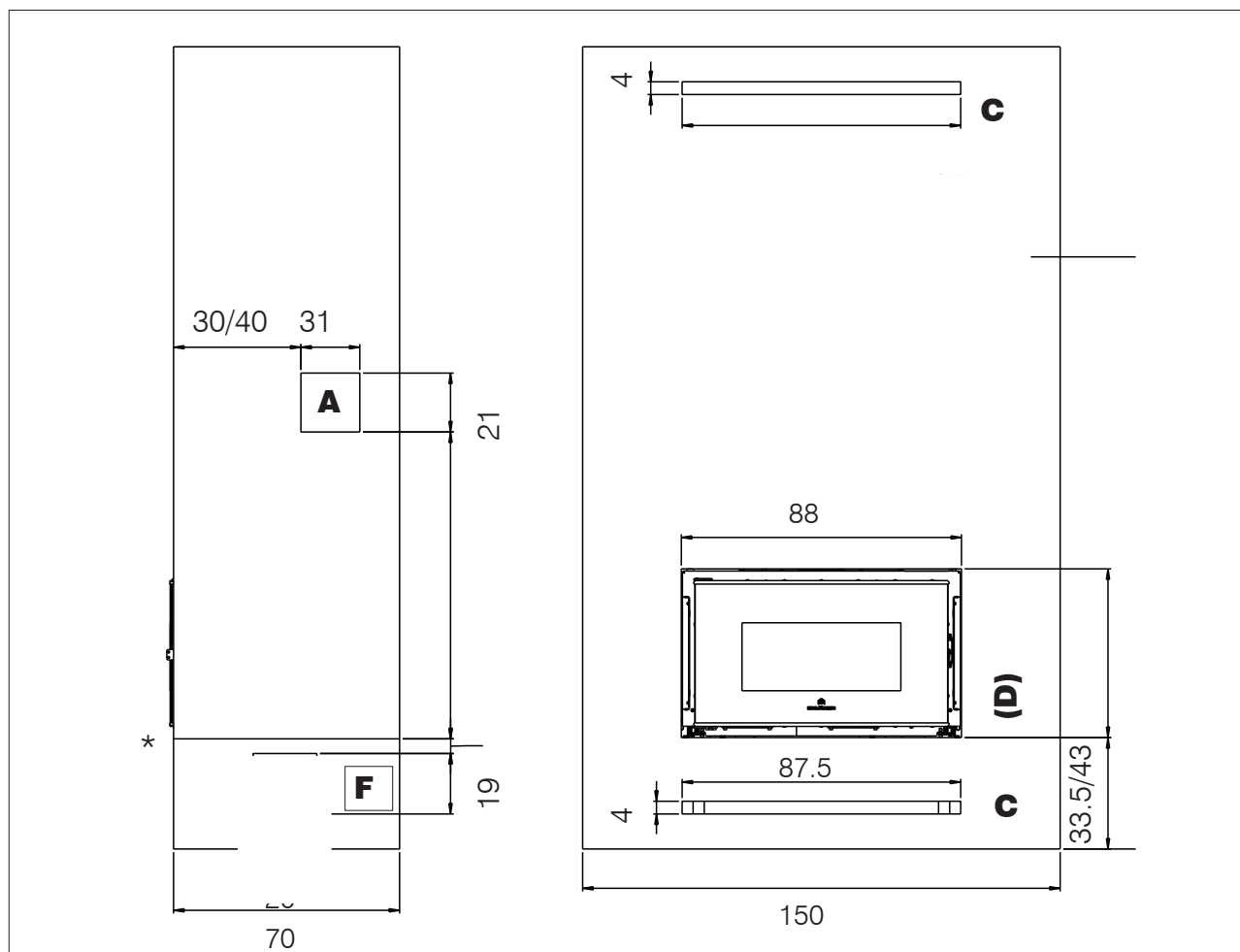

\* Do not exceed the height of the base with the cladding. This is so that the maintenance technician can slide the appliance out on its rails during maintenance work.

Legend

- A = hole for pellet loading hatch (on the side, can also be installed on the front)
- C = hole for compensation vent
- D = hole for the product
- F = hole for ventilation air recovery (a 10x10 cm hole in the side of the cladding)

**MEASUREMENTS (cm) OF HOLES ON PLASTERBOARD**

Label Vents	87.5 x 4
Pellet loading hatch	31 x 21
Hole for ventilation air recovery	10x10

The drawing represents the version with loading via a hatch.

<b>TECHNICAL SPECIFICATIONS as per EN 14785</b>			
For the installer: use the gasket provided and adjust the parameters with the TAC according to the conditions.			
	Nominal power	Reduced power	
Available power	12.7	4	kW
Yield	89.1	92.4	%
CO emissions at 13% O <sub>2</sub>	0.006	0.020	%
Smoke temperature	162	89.2	°C
Fuel consumption*	2.93	0.8	kg/h
Tank capacity	17		kg
Draw	11-6	10 - 3	Pa
Autonomy	6	21	hours
Heatable volume **	330		m <sup>3</sup>
Fume duct diameter (male)	80		mm
Air intake duct diameter (male)	50		mm
Weight including packaging	271		kg
Environmental class according to Italian Min. Decree 186	5 stars		
Energy efficiency class in accordance with EU regulation 2015-1186 (Classes A+ +/G)	A+		

\* A calorific value of 4.8 kW/kg was used to calculate consumption.

\*\* The heatable volume is calculated based on the assumption of a heating demand of 33 Kcal/m<sup>3</sup> hour.

\*\*\* Accessories for ducting hot air are available.

The product can work safely even with greater draught.

Excessive draught could cause the product to switch off and/or lower its performance.

**NOTE: the smoke outlet diameter does not match the chimney system diameter, which must be sized accordingly.**

<b>TECHNICAL DATA FOR SIZING THE FLUE</b>			
which must in any case satisfy the requirements in this sheet and the installation instructions for the product			
	Nominal power	Reduced power	
Smoke temperature at smoke outlet	180	100	°C
Minimum draught	0.01		Pa
Smoke flow rate	9.7	4.13	rps

<b>ELECTRICAL SPECIFICATIONS</b>	
Power supply	230 V AC +/- 10% 50 Hz
Nominal absorbed power	110 W
Reduced absorbed power	45 W
Absorbed power in stand-by mode	2 W
Power absorption during ignition	300 W
Remote control frequency (provided)	2.4 GHz
Protection rating	Fuse T4A, 250 V AC 5x20

**The data shown above is for illustration purposes and was measured during certification at the entity's premises. EDILKAMIN s.p.a. reserves the right to modify the product without notification in the interests of improvement.**



Edilkamin S.p.A.  
20045 Lainate (MI), via P. Mascagni 7  
Tel. +39 02 937621  
Fax. +39 02 93762 400/300  
mail@edilkamin.com  
www.edilkamin.com

Capitale € 4.100.000 int. vers.  
Sede legale:  
20154 Milano, Via P. Moscati 8  
Reg. Imp. di Milano 00192220192  
REA n° 878888  
Cod. Fiscale e Partita IVA 00192220192

TECHNICAL DOCUMENTATION FOR LOCAL SPACE HEATERS ACCORDING TO COMMISSION REGULATION (EU) 2015/1185 AND 2015/1186

Manufacturer	Edilkamin S.p.A.
Trademark	Edilkamin
Model Identifier	Pellkamin2 12
Description	Fireplace wood pellets
Indirect heating functionality	no
Direct heat output (space heat output)	12,6 kW
CPR harmonised standard	EN 14785
Notified Body	Acteco srl (Via Amman 41, 33084 Cordenons-PN-Italy) NB1880

Fuel	Preferred fuel (unique)	Space heating emissions at nominal heat output				Space heating emissions at minimum heat output			
		PM	OGC	CO	NOx	PM	OGC	CO	NOx
(*) PM = particulate matter, OGCs = organic gaseous compounds, CO = carbon monoxide, NOx = nitrogen oxides									
<b>Compressed wood with moisture content &lt; 12 %</b>	<b>yes</b>	<b>19</b>	<b>2</b>	<b>58</b>	<b>135</b>				

Observe the specific precautions for installation, assembly and maintenance indicated in the manual accompanying the product

Up to 1/1/2022	
$\eta_s$ [%]	81,0
EEI [%]	122
Energy Efficiency Class	A+

From 01/01/2022	
$\eta_s$ [%]	81,0
EEI [%]	122
Energy Efficiency Class	A+

Calculations according to the council commission regulation (EU) 2015/1186 and 2015/1185  
Characteristics when operating with the preferred fuel

$$EEI = (\eta_{s,om} \cdot BLF) - 10\% + F(2) + F(3) - F(4) - F(5)$$

$$\eta_s = \eta_{s,om} - 10\% + F(2) + F(3) - F(4) - F(5)$$

BLF = 1,45       $\eta_{s,om} = \eta_{th,nom}$   
F5 not of relevance

Heat output			
Item	Symbol	Value	Unit
Nominal heat output	$P_{nom}$	12,6	kW
Minimum heat output (indicative)	$P_{min}$	0,0	kW

Useful efficiency (NCV as received)			
Item	Symbol	Value	Unit
Useful efficiency at nominal heat output	$\eta_{th,nom}$	92,1	%
Useful efficiency at minimum heat output (indicative)	$\eta_{th,min}$	0	%

Auxiliary electricity consumption			
Item	Symbol	Value	Unit
At nominal heat output	$e_{l,max}$	0,175	kW
At minimum heat output	$e_{l,min}$	0,020	kW
In standby mode	$e_{l,sb}$	0,002	kW

Type of heat output/room temperature control (select one)	
single stage heat output, no room temperature control	NO
two or more manual stages, no room temperature control	NO
with mechanical thermostat room temperature control	NO
with electronic room temperature control	NO
with electronic room temperature control plus day timer	NO
with electronic room temperature control plus week timer	yes

$$F(4) = CC \cdot \frac{0,2 \cdot e_{l,max} + 0,8 \cdot e_{l,min} + 1,3 \cdot e_{l,sb}}{P_{nom}} \cdot 100[\%]$$

F (2)	7,0 %	up to 2022
F (2)	0,0 %	from 2022
Other control options (multiple selections possible)		
room temperature control, with presence detection		NO
room temperature control, with open window detection		NO
with distance control option		NO

F (3)	0,0 %	up to 2022
F (3)	0,0 %	from 2022

Contact details	
Name and address of the manufacturer	www.edilkamin.com
EDILKAMIN S.p.A.	mail@edilkamin.com
Via Mascagni 7	<b>Legal Representative</b>
20045 Lainate (MI) – ITALY	<b>Paolo Gusella</b>



**PREPARATION AND UNPACKING**

The packaging materials are neither toxic nor harmful and do not require special disposal.

The user is responsible for storing, disposing of and recycling them in accordance with the law.



Always move the stove vertically with suitable equipment and in compliance with safety regulations.

Do not turn the package over, and handle all parts requiring installation with care.



The warm ventilation air must be ducted to the outside or the fans can be directed frontally.

The product contains:

- remote control,
- warranty certificate,
- removable handle,
- this manual,

Check that all components are present and in good condition; if you encounter any problems, contact your dealer immediately.

There are two deflectors in the firebox **(D)** to be fitted as shown in the figure below

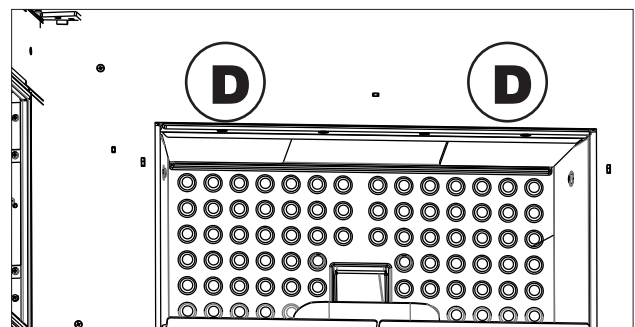
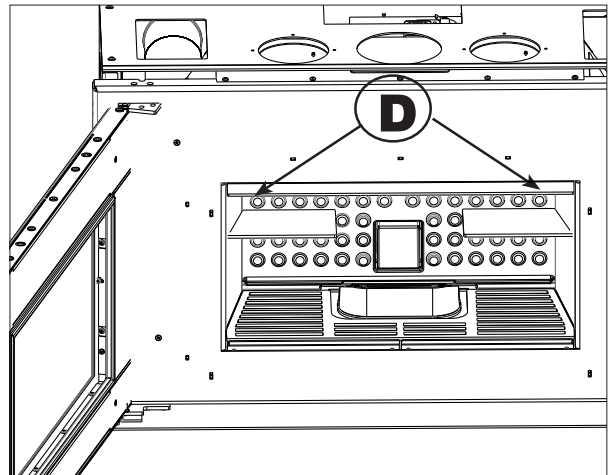
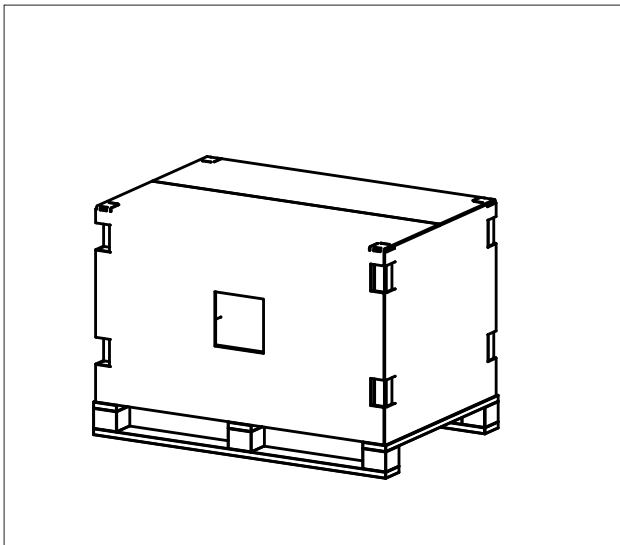

**TO UNPACK THE PRODUCT**

undo screws (A) as shown below

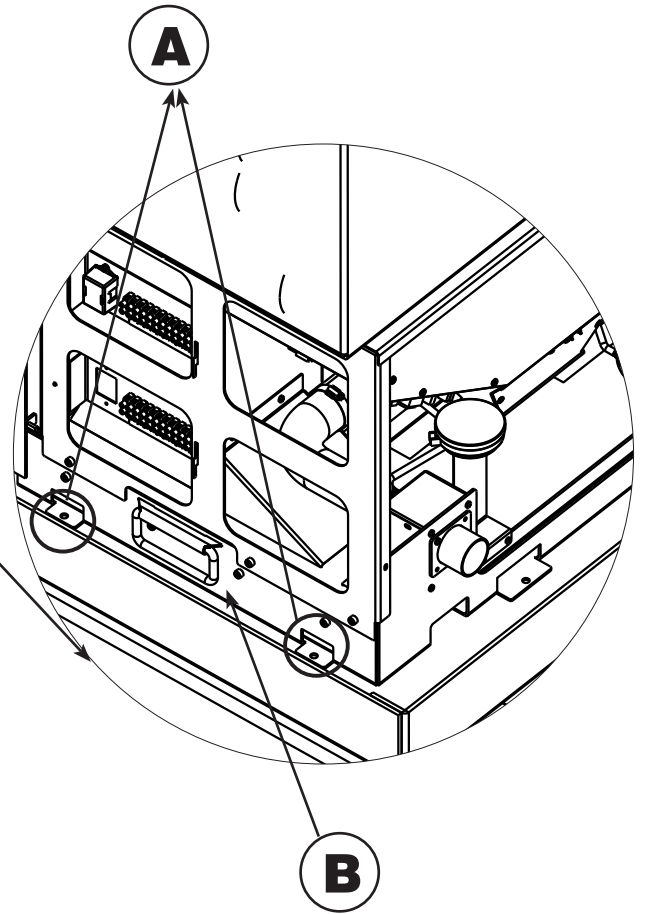
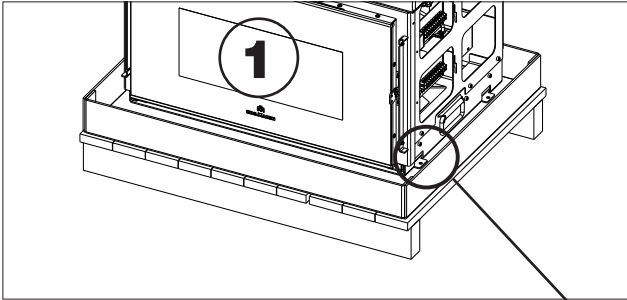

To facilitate handling, the PELKAMIN 12 EVO is fitted with handles **(B)**.

Do not use the holes for the air intake or fumes outlet as points for handling the appliance. This may lead to slight misalignments.

**SUMMARY INSTALLATION CHECKS**

For details, refer to the respective pages of this manual.

Element to be checked	What to check
Suitability of the room	<ul style="list-style-type: none"> <li>aeration</li> <li>intended use: do not install in bedrooms, bathroom or fire hazard areas</li> </ul>
Volume of room	<ul style="list-style-type: none"> <li>&gt; 30 m<sup>3</sup></li> </ul>
Load bearing capacity of the floor/base	<ul style="list-style-type: none"> <li>sufficient to support the product, its accessories and cladding</li> </ul>
Safety clearance from flammable materials	<ul style="list-style-type: none"> <li>see the respective paragraph</li> </ul>
Air intake	<ul style="list-style-type: none"> <li>existing and suitable</li> <li>see the respective paragraph</li> </ul>
Flue	<ul style="list-style-type: none"> <li>see the respective paragraph</li> </ul> In particular, it must be: <ul style="list-style-type: none"> <li>dedicated to a single appliance</li> <li>made of suitable material</li> <li>inspectable</li> </ul>
Power socket	<ul style="list-style-type: none"> <li>present, with regulatory grounding system</li> </ul>
Hole for ventilation air	<ul style="list-style-type: none"> <li>a hole at least 10x10 cm in size, preferably on the side of the covering</li> </ul>
Ducting for ventilation air *	<ul style="list-style-type: none"> <li>always channel the ventilation warm air (the 6 cm diameter pipe) to the outside The warm ventilation air must be ducted to the outside or the fans can be directed frontally.</li> </ul>

**INSTALLATION IN AN EXISTING FIREBOX**

**In addition to the above, check, in particular, for**

If you wish to install the appliance in an existing fireplace, you must bear the following in mind, in addition to observing all regulations and the instructions in this manual:

- there must be sufficient clearance around the Pellkamin
- the possibility of installing the appliance perfectly level on the base
- the need to install the loading hatch
- the existing cladding must be accessible. For maintenance purposes, the technicians are able to slide the Pellkamin out on its rails.

**ONLY QUALIFIED PERSONNEL CAN PERFORM THESE CONNECTIONS.  
ALL WORK MUST BE DONE WITH THE POWER SWITCHED OFF.**

**IN ORDER TO DIRECT THE LEFT FAN FROM POSITION 1 TO POSITION 2, DO THE FOLLOWING:**

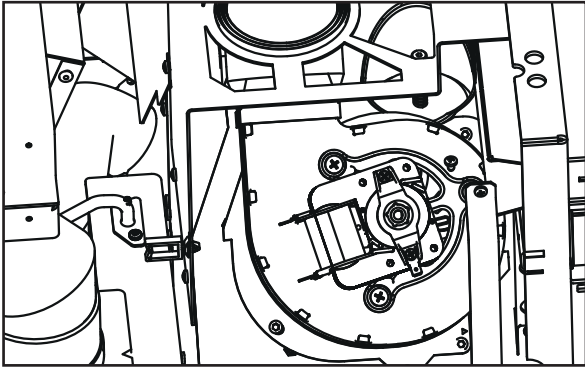

**POSITION 1**

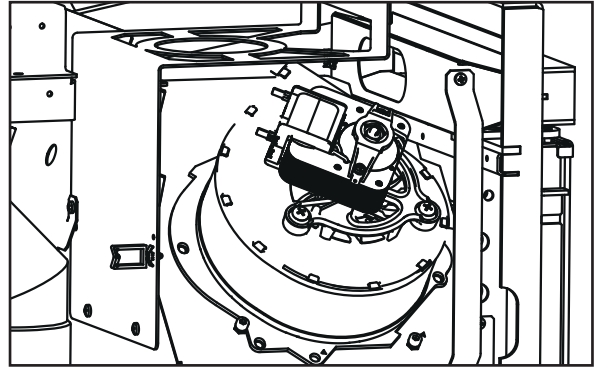

**POSITION 2**



**ONLY FOR TECHNICAL PERSONNEL,  
WITH THE APPLIANCE OFF AND  
THE POWER DISCONNECTED**

**REMOVE THE APPLIANCE**

PLEASE NOTE:  
TO PROCEED WITH THIS OPERATION, MAKE SURE  
THAT THE PRODUCT IS FIXED TO THE BASE

Proceed as follows for the removal:

- Undo the two front hex screws
  
- Pull it towards you as far as it will go.

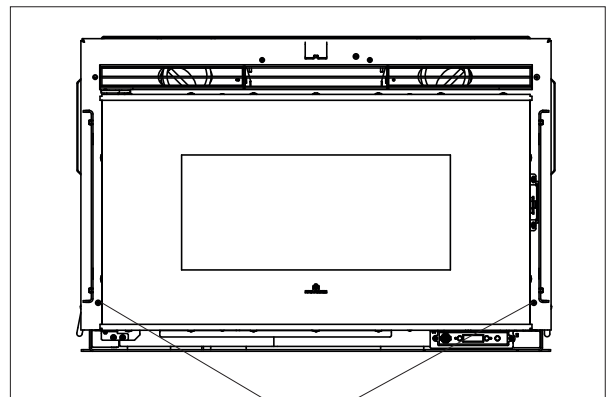

front hex screws

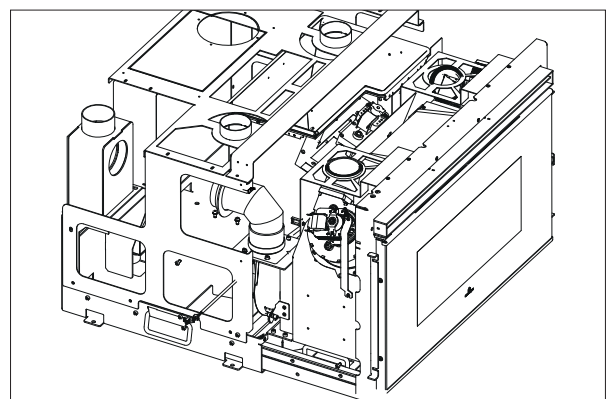

DISCONNECT FROM THE POWER SUPPLY AND  
DISMANTLE THE FAN BY UNSCREWING IT

REMOVE THE RUBBER UNION

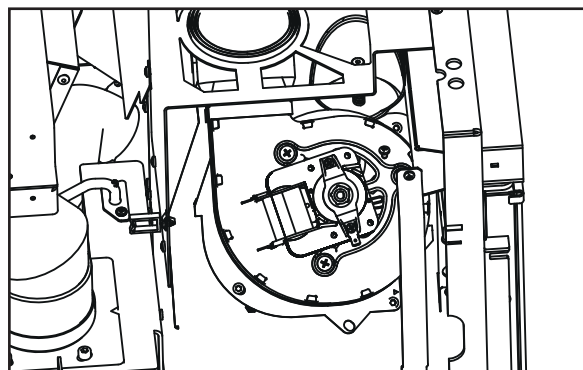

REFIT THE FAN TURNING IT ABOUT 45°, WITH ITS  
GASKET SCREW IT ON.

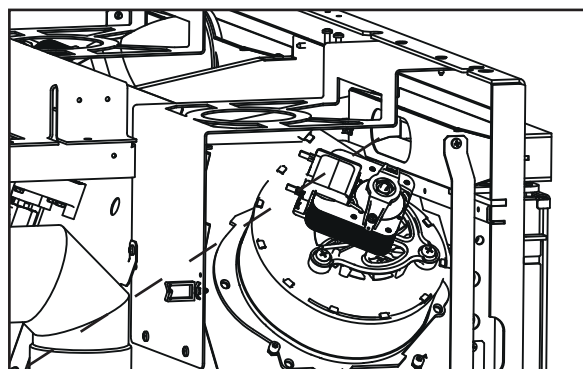

INSERT THE RUBBER UNION IN ITS HOUSING ON  
THE FRONT

RECONNECT THE FAN TO THE POWER SUPPLY

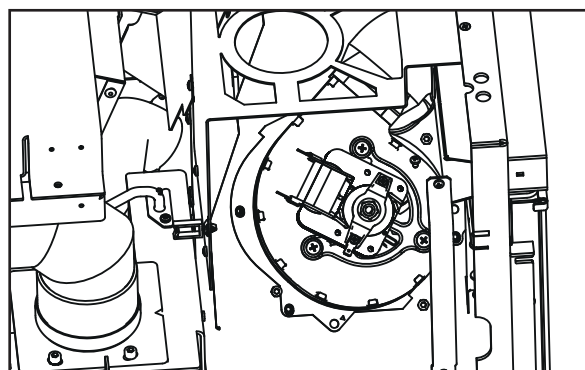

**REMARKS ON INSTALLATION**

Please note that:

- Installation must be carried out by authorised technical personnel.
- the appliance must be installed and used in compliance with all local and national laws and European regulations; The applicable Italian regulation is UNI 10683.
- if installed in a condominium, the appliance must be approved by the administrator.

Below are a few general instructions which, however, do not obviate the need to comply with local regulations and do not imply any liability on the installer's job.

**Checking the suitability of the room of installation**

- The room must have a volume of at least 30 m<sup>3</sup>.
- The floor must be able to bear the weight of the product and its accessories.
- Level the appliance
- The appliance cannot be installed in the same room as other equipment which draws air for combustion from the room itself or any area with an explosive atmosphere. Any extraction fans operating in the same room or area as the product may affect its draught.
- In Italy, verify the compatibility pursuant to the UNI 10683 and UNI 7129 standards in the presence of gas-fired products.

**Protection from heat and safety clearances**

The surfaces of the building adjacent to the product must be protected against overheating.

The insulation to be used will depend on the type of surface in question.

Observe the following clearances from flammable materials:

- 10 cm at the sides and back

**Positioning the product**

The product is designed to operate in all climate conditions. In special circumstances, such as strong wind, the safety devices may intervene to switch the appliance off.

Contact the authorised Edilkamin Technical Assistance Centre.

**FLUE SYSTEM****(Fumes duct, flue and chimney pot)**

This chapter has been drawn up pursuant to European regulations EN 13384, EN 1443, EN 1856 and EN 1457. The installer must observe both these and any other local regulations. This manual does not in any way substitute such regulations.

The product must be connected to a smoke exhaust system which ensures that the smoke produced by combustion is expelled in complete safety.

Before positioning the appliance, the installer must check that the flue is suitable.

**SMOKE DUCT, FLUE**

The smoke duct (which connects the combustion chamber smoke outlet with the flue inlet) and the flue itself must, among other regulatory requirements:

- receive the smoke from a single product (the outlets of multiple appliances may not be conveyed into a single flue)
- be routed vertically for the most part
- have no downwards sloping sections
- preferably have a circular internal cross section, or with a ratio of the sides of less than 1.5
- terminate at roof level with a proper chimney pot: the flue may not discharge directly on the wall or into an enclosed space, even if the space in question is open to the sky
- be made of material with rated fire reaction class A1 as per UNI EN 13501 or analogous national regulations
- be appropriately certified, with a suitable chimney plate if made of metal;
- keep the initial section

**THE SMOKE DUCT**

In addition to the general requirements for the fume duct and the flue, the fume duct:

- may not be made of flexible metal material
- must be insulated, if routed through unheated areas or outdoors
- must not be routed through rooms where the installation of combustion heat generators is prohibited, or that are subject to potential fire, or that cannot be inspected;
- must enable the recovery of soot and be open for inspection
- have at most 3 bends with a maximum angle of 90°
- must have at the most one single horizontal section with a length of no more than 3 metres, depending on the draw. Note, in any case, that long sections encourage the accumulation of dirt and are harder to keep clean.

**THE FLUE:**

Further to the general prescriptions for the fumes duct and flue, the flue:

- must only be used for discharging fumes
- must be correctly sized to satisfy the requirements for flue gas discharging (EN 13384-1)
- must preferably be insulated, made of steel and with a round inner cross-section. If rectangular, the corners must have a radius of not less than 20 mm, with a ratio of the internal dimensions of <1.5
- must normally be at least 1.5 metres in vertical length
- must have a constant cross section
- must be waterproof and thermally insulated to ensure proper draught
- preferably mount a collection chamber for unburnt residues and any condensate build-up;
- if pre-existing, it must be clean to prevent fire hazards;
- in general, we recommend fitting a tube inside the existing masonry chimney if its diameter is greater than 150 mm.

**EMBEDDED SYSTEM:**

Further to the general prescriptions for the fumes duct and flue, the intubated system:

- operate in negative pressure;
- be open to inspection;
- comply with the local regulations.

**THE CHIMNEY POT**

- must be anti-downdraught;
- must have an internal cross section equivalent to that of the flue and a fumes outlet at least double that of the interior of the flue
- for dual flues (which should be spaced at least 2 m apart) the chimney pot receiving the fumes from the solid fuel appliance or that from the higher storey, must be at least 50 cm higher than the other;
- must extend beyond the back-flow zone (in Italy, refer to UNI 10683 point 6.5.8.);
- must allow for maintenance of the chimney.

**(EXTERNAL) COMBUSTION AIR INTAKE**

We suggest two alternative ways for ensuring a proper flow of indispensable combustion air.

**Air intake without direct connection to the appliance**

Install an air outlet at floor level with an effective surface area (net of the screen or other protections) of at least 80 cm<sup>2</sup> (10 cm in diameter).

To prevent draughts, we recommend installing the intake behind the appliance.

Installing it in front of the appliance will create unpleasant draughts.

**Air intake with direct connection to the appliance**

Install an air intake with an effective size (net of the mesh or other protective equipment) that is at least equal to that of the air intake at the back of the appliance.

Connect the air intake to the appliance's air intake with a pipe that may also be flexible. Increase the pipe diameter if the pipe is not smooth: assess any load loss.

Our advice is not to exceed 1 m in length and not to use more than one curve, depending on the draw of the flue, and not to connect it downwards so as to avoid interference with the fan.

The air may be drawn from an adjacent room only if:

- the flow is taken from permanent, unobstructed openings communicating with the outdoors
- the air pressure in the adjacent room is never reduced to a level below outdoor pressure
- the adjacent room is not a garage, subject to fire hazard, a bathroom or a bedroom;
- the adjacent room is not a shared room in the building.

In Italy, UNI 10683 provides that ventilation is sufficient even if a pressure difference between the outdoors and indoors of no more than 4 PA is guaranteed (UNI EN 13384-1). The installer who issues the declaration of conformity is responsible for ensuring these conditions.

**VENTILATION AIR EXCHANGE**

In addition to the combustion air inlet (which must draw air from the outside as described above), and the booster vents, an opening at least 10x10 cm in size must be made for the ventilation air exchange. This hole should be made in the cover.

**CHECKING THE ELECTRICAL CONNECTIONS  
(the power socket must be located in an  
easy-to-access position)**

The product is supplied with an electrical power cord for connection to a 230 V 50 Hz socket, preferably one equipped with a residual-current device (any power supply extension cable to be provided by the installer).

Voltage variations in voltage of greater than 10% can affect operation of the product.

The electrical system must be compliant; check the operation of the earth in particular.

Edilkamin is not responsible for malfunctions resulting from an improperly earthed system.

The power line must be of adequate section for the power of the appliance.



The power supply cable:  
- must not come into contact with the flue or other hot parts of the product;  
- must not be crushed under the plate.

**POWER CONNECTIONS TO OPTIONAL COMPONENTS**

There is a terminal board on the product (visible after removing the right-hand side panel) to which the installer may connect a home-automation probe or an NTC room probe for ducted versions. The number of probes that can be connected is equal to the number of ductable fans.

black	green	white
emergency room probe	ducting room probe	AUX

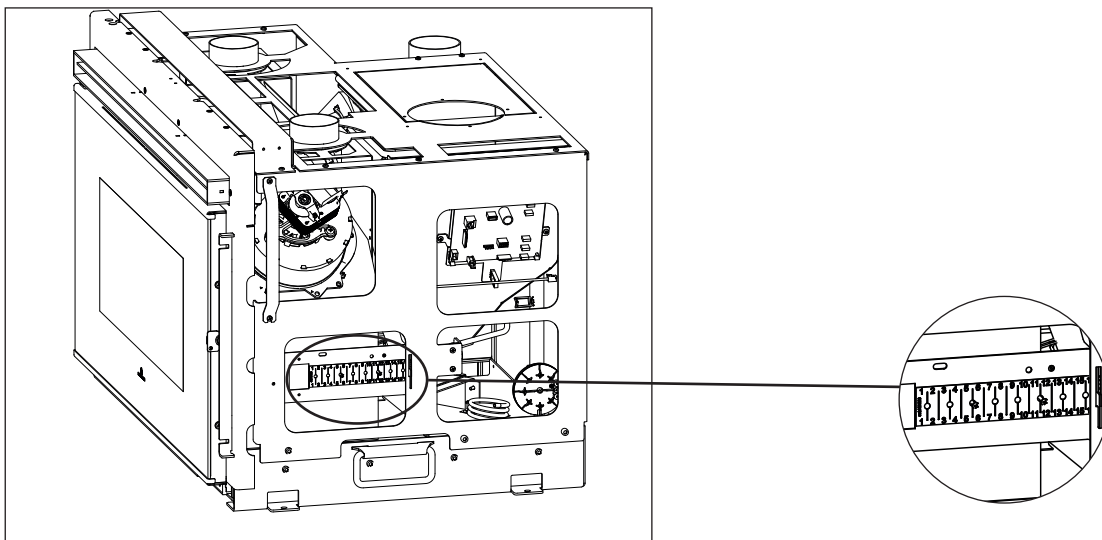



**MOUNTING TO THE BASE**

Use the provided screws to secure the appliance to the base.



Failure to observe the above instructions can cause the insert to tip over resulting in serious damage and injury to the user.

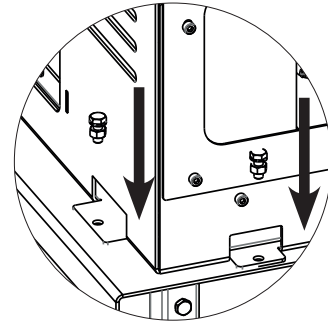

**Facings, gather hood and vents**

Face the product only after having completed the following steps:

- check that the product is level.
- connection of the product to the smoke outlet and air intake
- inspection of the product when hot.

The installer must implement all installation best practices and take all the necessary precautions against overheating and fires, in particular:

- if a plinth is constructed beneath the hearth level, it must include a suitable slot for the passage of recirculation air from the room;
- wooden parts must be protected with fireproof panels, which must not be placed against one another but spaced at least 1 cm apart to enable air to flow and prevent heat build-up.

The interior of the mantel should be aerated by exploiting the flow of air coming from below which convective currents will cause to exit from the grille on top, thus allowing heat recovery and preventing undue overheating; our advice is as per the previous page.

In addition to that mentioned above, take into account the regulations in force in the relevant country concerning “insulation, finishes, facings and safety recommendations”.



Verify that the product works properly before applying the cladding.

Testing should be done when lit and in normal operation for a few hours, before fitting the cladding so that any adjustments can be made easily.

Consequently, the finishing operations, such as construction of the mantel, fitting the cladding, making the pilasters, painting, etc., should be done when the testing has been completed successfully. Edilkamin is not liable for any costs arising from the demolition or reconstruction of such works, even if such work is the result of having to replace any defective parts.

**INLET SURROUND**

The inlet surround is used to fill the gap remaining between the fireplace frame and the cladding.  
IT IS SUPPLIED WITH ONE OF THE TWO OBLIGATORY KITS FOR LOADING PELLETS, WITH A TRAY OR HATCH

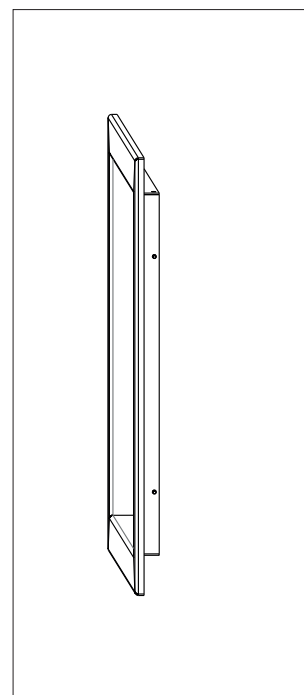

**INITIAL START-UP PHASES**

- Make sure you have read and understood this manual
- Remove all flammable materials from the appliance (manuals, labels, etc.). In particular remove any labels from the glass.

**FUEL**

Use Class A1 wood pellets conforming to the UNI EN ISO 17225-2 standard or similar local regulations envisaging, for example, products with the following characteristics:  
 diameter 6 mm  
 length 3–4 cm  
 humidity < 10%

For reasons relating to safety and environmental protection, DO NOT burn plastic, painted wood, coal or bark fragments in the stove.  
 Do not use the product as an incinerator.



During the first ignitions, there may be a slight smell of paint, which will disappear in a short time.



Caution  
 Using fuels other than those specified can damage the appliance.



**AS WITH ALL APPLIANCES, THIS PRODUCT HEATS UP AND COOLS DOWN DURING THE VARIOUS OPERATING PHASES. THIS IMPLIES NORMAL EXPANSION MOVEMENTS. THESE EXPANSION MOVEMENTS MAY CAUSE SLIGHT ADJUSTMENT NOISES THAT CANNOT CONSTITUTE GROUNDS FOR COMPLAINTS.**

**LOADING PELLETS INTO THE TANK.**

Depending on the version, you can load the pellets:

- via the trapdoor
- via the front drawer

Use the glove when the appliance is hot. The pellets can be loaded even when the fire is burning.

**OPERATION**

<b>Mode</b>	<b>Settable parameters</b>
MANUAL	<ul style="list-style-type: none"> <li>power level</li> <li>ventilation level (if there are two or more fans, they can be adjusted separately)*</li> </ul>
AUTOMATIC	<ul style="list-style-type: none"> <li>desired room temperature</li> <li>ventilation level *</li> </ul>
CRONO	<ul style="list-style-type: none"> <li>desired room temperature, selected per day of the week</li> <li>ventilation level*</li> </ul>

\* by lowering ventilation, the product can also automatically modulate the power to maintain maximum performance and avoid overheating. Where necessary, a safety function is provided: if for reasons of use or installation the set ventilation does not allow the necessary heat dissipation, the maximum ventilation is automatically started.

The product also has the following supplementary functions.

Function	Modes in which it can be activated	What it does
Stand-By	automatic crono	when the desired temperature is reached, the product switches off and then back on again when the temperature drops
RELAX (not provided for some types of products)	manual automatic crono	enables natural convection mode (fan off), thus reducing the power
EASY TIMER	manual automatic	can be used to programme the switching off/on after a set number of hours (maximum 12 hours)



**INTERFACE**

The product can be managed alternatively as follows

**STANDARD**

- **Bluetooth** REMOTE CONTROL: can be used for all functions, near the product
- **The Mind** APP  : useful for all functions at home with direct connection or outside the home with internet connection and registration

If necessary, a few functions can also be managed from a

- **SAVE PANEL**: placed on the product

By purchasing the Edilkamin **optional elements**:

- **VOICE CONTROL SYSTEMS**: Alexa or Google Home

**OPTIONAL ELECTRICAL CONNECTIONS**

On the product (accessible by removing the coating, with the electricity off and only by qualified technicians) a dedicated low voltage terminal block can be found

**-Pin 1-2 = zone 3 ambient input = probe or thermostat of the relative zone**

**-Pin 3-4 = zone 2 ambient input = probe or thermostat of the relative zone**

**-Pin 5-6 = home automation input = commercial telephone dialler or remote On-Off or Thermostat.**

**NOTE:**

The connections must be made by qualified personnel, with the electricity disconnected.

More info for installers on the site.

terminal block example

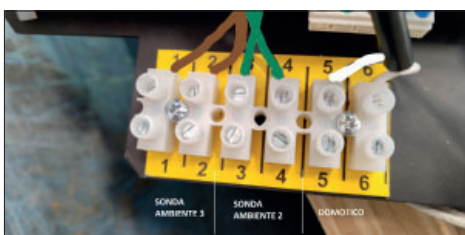

In case of connection of probes or thermostats on the room inputs, the relevant parameters must be set in the Technical Menu of the appliance.

There are two possible modes of operation. The installer can help you choose, according to your needs:

	<b>Thermostat on home automation contact</b>	<b>Thermostat in place of the ambient probe on the electronic board</b>
ACTION	The product turns on/off without any modulation.	the product modulates, goes into stand-by and turns on/off

**REMOTE CONTROL**

The remote control has specific functions for three distinct figures:

- **USER** of the product (operations not protected by password)
- **INSTALLER** (operations with dedicated password because any errors can jeopardise the product's operations and SECURITY)
- **EDILKAMIN TECHNICAL ASSISTANCE CENTRE (TAC)** (operations with dedicated password because any errors can jeopardise the product's operation and SECURITY).

**Characteristics:**

Module for RF transmission and reception with 2.4 GHz frequency - Recommended power supply 3 x AA slimline 1.5 VDC batteries (with at least 1600 mAh capacity).



Risk of explosion if the batteries are replaced with other unsuitable batteries.

**REMOTE CONTROL POWER SAVING**

After 20" of non-use the backlighting decreases and after a further 10" the display switches off. If any button is pressed with the display on, the counter resets. If any button is pressed while the display is off, the display and the backlighting will switch on and the counter will reset.

This only refers to the remote control, not the product itself.

In normal use, the remote control's batteries should last a year. This duration is for illustrative purposes only. Edilkamin and the reseller will not consider claims for battery life under any circumstances.

**If on the initial start-up** the language was not set, the screen for setting the language will appear. Choose the language with the +/- buttons and confirm with OK.









 Bluetooth communication present between the product and the PCB. If there is no communication, the symbol disappears.

 On only if the battery is running out.

 Maintenance necessary symbol.

 Appears after a certain number of hours of operation. In some models the symbol may be linked to a fuse problem on the board. In any case, contact the TAC.

 The relative function is active (Relax – airKare – EasyTimer – Crono).

**EasyTimer and Crono cannot be activated simultaneously.**

 Reserve indicator. It switches on if the function is active. The arrows switch on in sequence to signal that the tank must be filled.

 Presence of flame and stove power

POWER ON

POWER LEVEL 1

POWER LEVEL 2

POWER LEVEL 3

POWER LEVEL 4



POWER LEVEL 5





Visualisation of the status of the fan(s).

If the product has not heated up, no symbol will appear.

- FAN OFF: 
- SPEED 1 
- SPEED 2 
- SPEED 3 
- SPEED 4 
- SPEED 5 
- AUTOMATIC 



Indicates that the product has switched off after the target has been reached with stand-by mode active. DOES NOT indicate that the function is enabled.

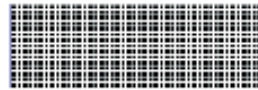

Bottom bar for "Weekly Hour Schedule" and "Messages".

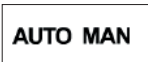

Automatic or Manual mode: the product's air power depends on the room temperature or is set by the user.

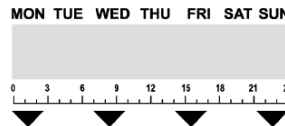

Days of the week and time bar. They only appear if the timer (Crono) has been activated.



Setting. Indicates that the remote control is in the setting mode. The settable value will appear in the bottom bar.



Digits for SET-POINTS. Setting of the various SET-POINTS: temperature, power, fan speed.

**POWER ON/POWER OFF**

These operations will take a few minutes, during which the flame must appear or extinguish. Simply wait without taking any action.

The ON/OFF button is used to manually start the on or off phase.

**During the switch-on,**

the display will show the status (CLEANING; SWITCH-ON; etc.)

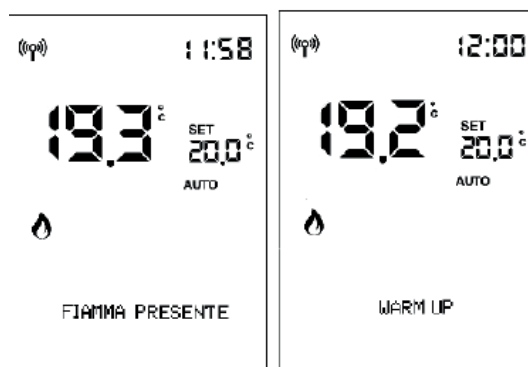
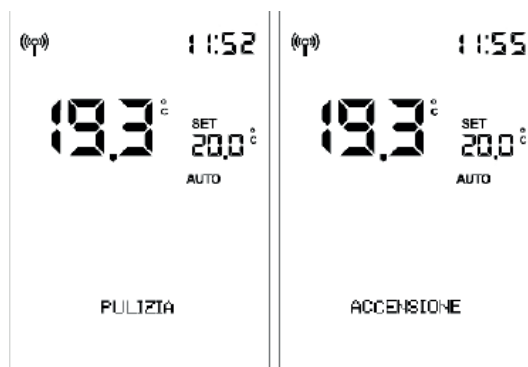

**During switch-off,**

the display shows the message "SHUTDOWN".



**If time programming is active,**

the status and programming are displayed alternately (3 seconds) on the status bar:

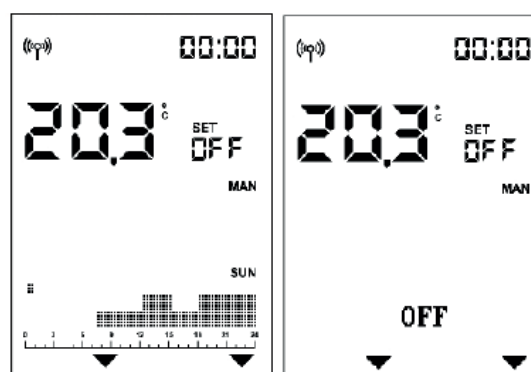

**AUTOMATIC and MANUAL setting**

Press the AUTO/MAN button to switch from manual to automatic mode or conversely.

AUTOMATIC

MANUAL

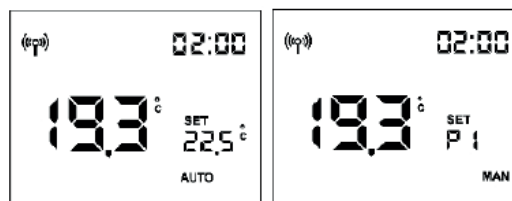

**In AUTOMATIC mode:**

**Setting the room temperature** (read by the remote control, which should be in the room where the product is installed).

Example: press a button and activate the display, then press the  button

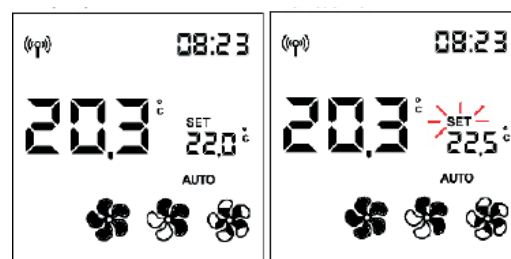

**In MANUAL mode:**

**Setting of the power**

Modify the power level (displayed by the flame symbol) using the “+” and “-” buttons.

For example: press any button and the display will activate, then press the  button

“flame” symbol

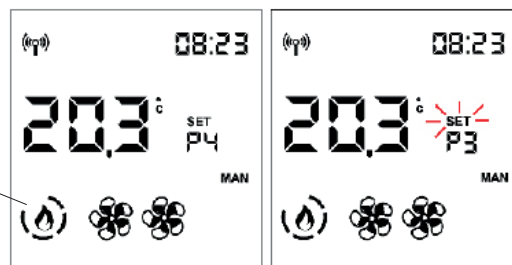

The setting can be confirmed with the  button or by waiting 5” without pressing any button. After confirming, SET will stop flashing.



**NOTE:**

**With the timer active and the product switched off,** neither the temperature nor the power can be adjusted.

**- FAN ADJUSTMENT**

The setting can be made with the stove turned OFF or ON.  
If the backlight is switched off, it can be activated by pressing any button.

Then by pressing the button  or  SET flashes and instead of the environment Set, the indication of the number of the fan being edited appears (F1).

The fan speed can be increased or decreased with  or  in the following sequence:

1 -2 - 3 - 4 - 5 - AUTO - for the front fan (1)

OFF-1-2-3-4-5- AUTO for ducted fans (2 and 3)

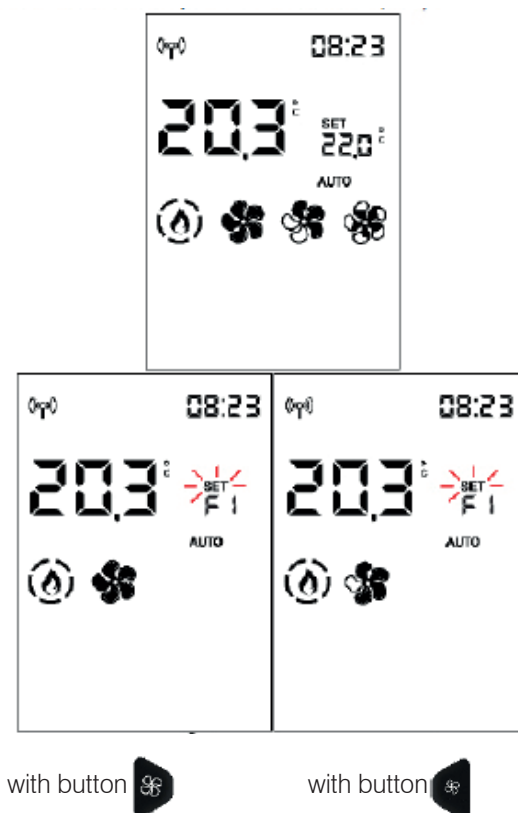

You can confirm the setting with the  button and then move to the next fan, if present (only for PLUS ducted versions), otherwise you can exit the fan setting page and "SET" will stop flashing.

Wait 5" without pressing any button to exit the fan setting, and SET will stop flashing.

Pressing the  button to confirm will take you to the next fan (Fan 2), if present.



Pressing the  or  button modifies the fan speed.

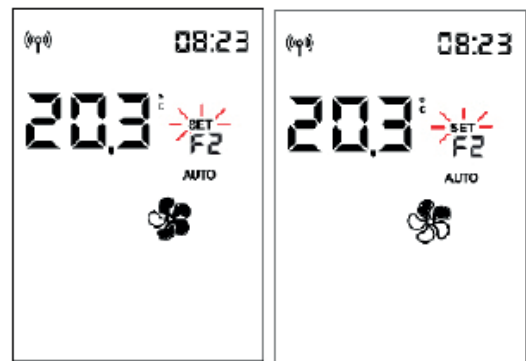

You can confirm the setting with the  button and then move to the next fan, if present, otherwise you can exit the fan setting page and "SET" will stop flashing. Alternatively, wait 5" without pressing any button to exit the fan setting, and "SET" will stop flashing, even if there are other fans.

Pressing the  button to confirm will take you to the next fan (Fan 3), if present. Waiting 5" without pressing any button takes you back to the home page with the modified SET.

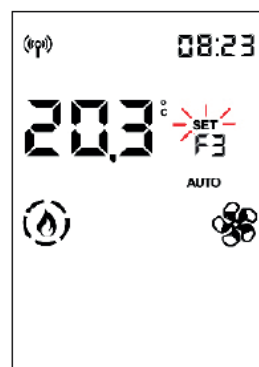

**WITH OPTIONAL ROOM PROBE**

**DUCTED ZONES 2 AND 3 ROOM SET-POINT**

The setting can only be made with ducted-air stoves. If two or more optional room probes are connected and activated, it is possible to set the relative room set-point and display the room temperature.



After setting the installation room temperature (or with the room power in manual mode), wait 5" without pressing any button and "SET" will flash then you will exit the settings page.

Otherwise, if you confirm with the  button, you can set the room set-point for zone 2 (if the probe is present and active) indicated on the bottom bar.



Press OK to move to the next zone (zone 3), if present, or exit.

**- RELAX FUNCTION**

Natural convection function (without ventilation) with automatic power limiting.

This function is available in all modes: automatic, manual and crono.

Press the  button to activate the Relax function.

Its activation on the display will be signalled by the arrow relative to the Relax button

Again by prolonged pressing of the  button, the function is disabled.

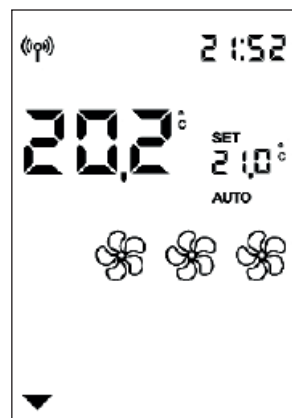

The product reduces its power output and after a few minutes switches the fan off too.

**NOTE:**

While the Relax function is active, it is not possible to increase the power to level P5.

**- AIRKARE FUNCTION**



This function is available as a standard feature on certain models and as an optional feature on other models: check which model you have.

The function, if available, can be activated with the product either on or off, in any mode (except in alarm mode).

The airKare can be activated or deactivated by pressing the dedicated  button

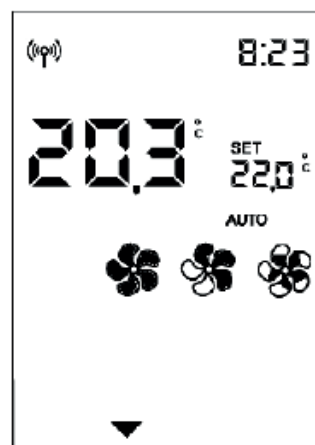

Its activation on the display will be signalled by the arrow relative to the airKare button.



**- EASY TIMER FUNCTION (delayed switching off and on)**

This function switches the product on/off after a set period from activation of the function.

This is convenient if you go to bed and want the product to switch on/off after a few hours (maximum 12 hours).

**The Easy Timer function can be activated by pressing the dedicated button**



By activating the Easy Timer function with the product on, the switch-off time can be set with ½ hour intervals.

By activating the Easy Timer function with the product off, the user sets the switch-on time.

Pressing the OK button or after 5" without pressing any button, the countdown will start with 5-minute intervals.

Example: Switch-ON in 1/2 hours' time.



The bar will continue to show the countdown which decreases until the product switches on or off.

The Easy Timer function can be deactivated by pressing the dedicated button.

The display will show an arrow above the button and the countdown.

To vary the timer before the switching on or off, it must be deactivated and then reset.

## CRONO

**After setting the times, temperatures or power levels in the CRONO MENU,** if the product is in automatic mode, the timer will work at room temperature, otherwise at the power setting.

Pressing the  button allows for switching from Crono in Temperature and Crono to Power and vice versa.



Briefly pressing the  button activates or deactivates the timer (programmed in advance from the app or remote control).

## NOTE

The timer is programmed from the MENU. The timer button is only used to activate/deactivate the function.

**- MENU**

It can be accessed by pressing the  button and the first Menu item will appear.

You can scroll the menu items with the  and  buttons, and enter the item with the  button

The menu items appear in the following order:

- STAND-BY**
- PELLET LOAD**
- CRONO**
- TEMP. CRONO**
- DATE-HOUR**
- LANGUAGE**

The following functions must be taken into account only following indications from the technician. Therefore, we do not report the complete explanation in this document

- DISPLAY**
- INFO**
- SOFTWARE**
- DATA**
- ALARMS**
- PELLET FALL**
- PELLET SENSOR**
- TECHNICAL MENU**
- SET TEMPERATURE**

The set-point digits contain the progressive number of the menu item, while the status bar includes the description of the menu item in large letters.

**NOTE**  
Depending on the version, the order of the items may vary.



**We recommend, at the end of installation and commissioning, to check all the daily operations and useful documents with the technician.**

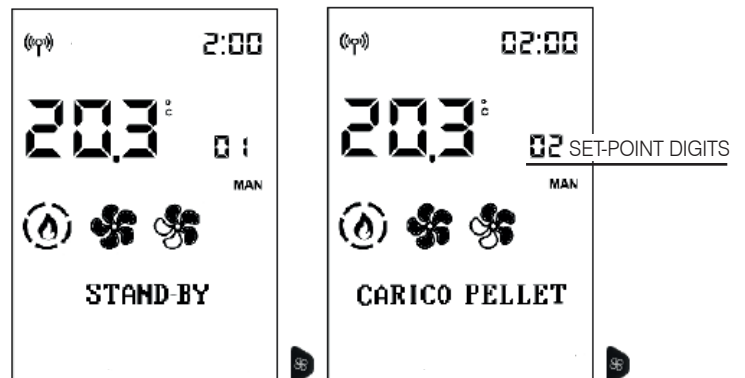



To exit the menu, press 

**STAND-BY**



When the Stand-by function is active, in the automatic and crono modes, the product switches off once the temperature set-point is reached and turns on again when the room temperature drops below the chosen value.

When the Stand-by function is not active, the product sets itself to minimum power when the temperature set-point is reached.

To access the function from the main menu (as indicated in the Menu section above), press the MENU button.

You can scroll the menu items with the  and  buttons, and enter the item with the  button

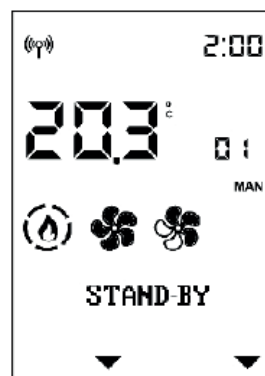
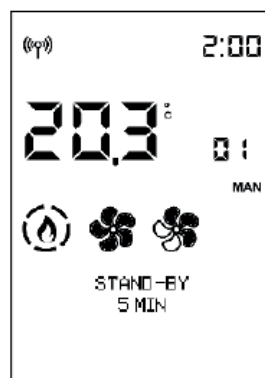
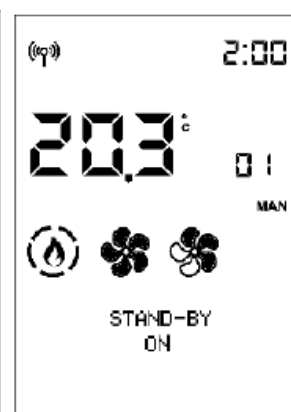
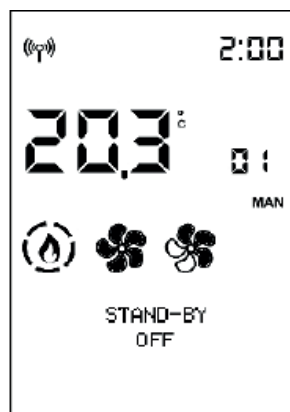

After entering the Stand-by function, the display will show the name of the function on the first line of the status bar and the current value on the second line (OFF if deactivated, ON if active).

The  and  buttons can be used to modify the value from Off (function deactivated) to On (activated) and the  button can be used to confirm.



Pressing the  button with the value ON activates the function and the display will propose to choose how many minutes must pass before the device switches off in stand-by mode.

(example 5 minutes)

The  and  buttons can be used to modify the time, and the button  to confirm

Pressing the  button automatically takes you to the first level.



**PELLET LOADING**

Allows you to load pellets after the pellet tank has been completely emptied.





Useful for the technician during the initial start-up.

Available only in the OFF status. Any attempt to activate the function in other statuses will not be allowed.

To access the function from the main menu (as indicated in the Menu section above), press the MENU button.

You can scroll the menu items with the  and  buttons, and enter the item with the  button

Once you have entered the **PELLET LOAD** function, the display shows the name of the function on the first line of the status bar and the current value on the second line (OFF if disabled, ON if enabled).



The  and  buttons can be used to modify the value from Off (deactivated) to On (activated) and conversely, while the  and  buttons are used to adjust it.

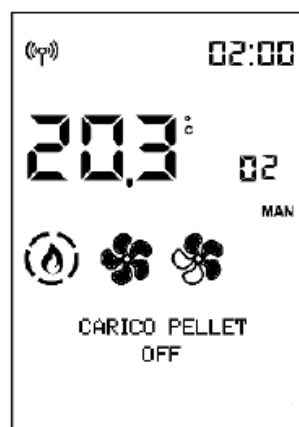

Pressing the  button automatically takes you to the first level.



**- CRONO**



To access the function from the main menu (as indicated in the Menu section above), press the MENU button.

You can scroll the menu items with the  and  buttons, and enter the item with the  button

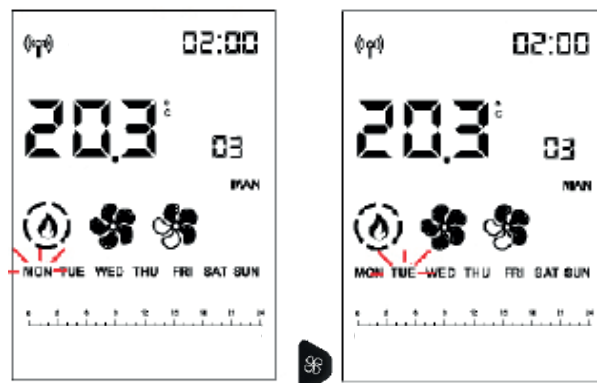

Choose the day of the week by scrolling the  and  buttons (you will simultaneously see the programme for that day) and confirm with the  button.



The cursor (rectangular) positions itself on 00:00.  
The time at the top RH shows the start of the time slot



Use the  and  buttons to scroll the time with 1/2-hour steps, by moving the cursor and displaying the pre-set level.

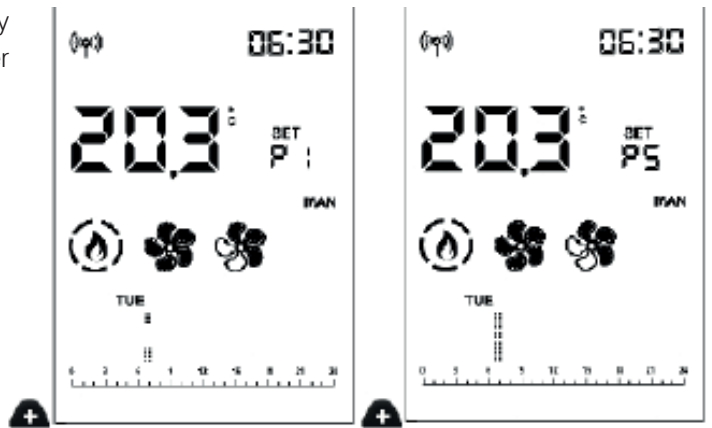

The  and  buttons can be used to modify the temperature levels (OFF – T1 and T2) or the power levels (OFF – P1 and P5).



After reaching 23:30 you must go backwards.

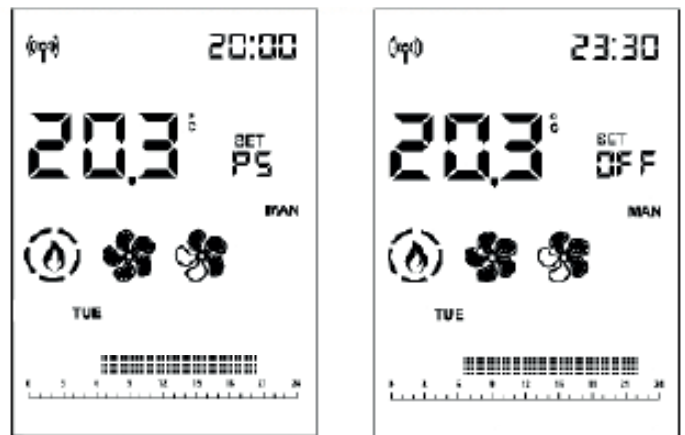

If you shift by pressing and holding the  or  buttons for more than 2", you copy the previous level onto the next level with a 1/2 h frequency per second.

The level can be copied also with backward shifts.





After setting the entire day, confirm with the  button



The copied day of the week flashes and you can shift to the next day using the  and  buttons

Confirm with the  button

Briefly pressing the  button allows you to exit the programming mode, but the programme will not activate.

To activate it, you must briefly press the  button again from the main page.

## NOTES

The switching on and off of the product can be forced with the timer active, by pressing the ON/OFF button for 2".



Only with the Stand-by function active will the product switch off once the set temperature has been reached.



**TEMP. CRONO (T1-T2)**

Temperature setting for timer T1 – T2



To access the function from the main menu (as indicated in the Menu section above), press the MENU button.

You can scroll the menu items with the  and  buttons, and enter the item with the  button

After entering the T1-T2 function, the display will show the name of the function on the first line of the status bar and the current value of T1 on the second line. T1 is the lowest temperature, T2 the highest.

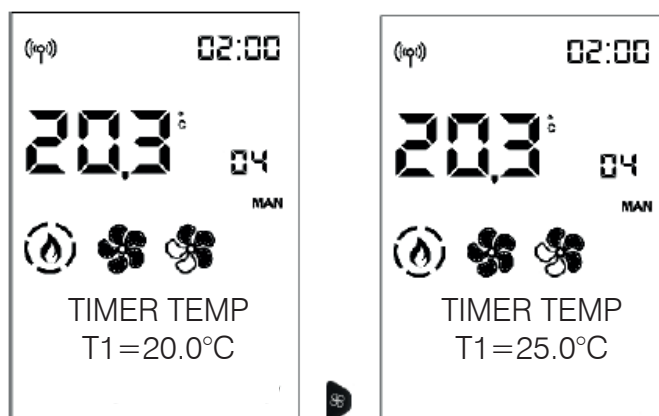
Use the  and  buttons to move to set-point T2 setting.



Modify the values with the  and  buttons and confirm with the  button

Pressing the  button automatically takes you to the first level.



**DATE-HOUR**

Can be used to set the current date and time.

To access the function from the main menu (as indicated in the Menu section above), press the MENU button.

You can scroll the menu items with the  and  buttons, and enter the item with the  button

After entering the Date-Time function, the display will show the name of the function on the first line of the status bar and the current value of the first setting (12/24 hours) on the second line.

You can switch from 12 to 24 hours using the  and  buttons and confirm with the  button



You reach the AUTO SUMMER TIME item (OFF if deactivated ON if activated)

You reach the WEB SYNC item (OFF if deactivated ON if activated)

At the end the item SET HOUR will appear and it will be possible to modify the hours first with buttons + and - and confirm with the  button

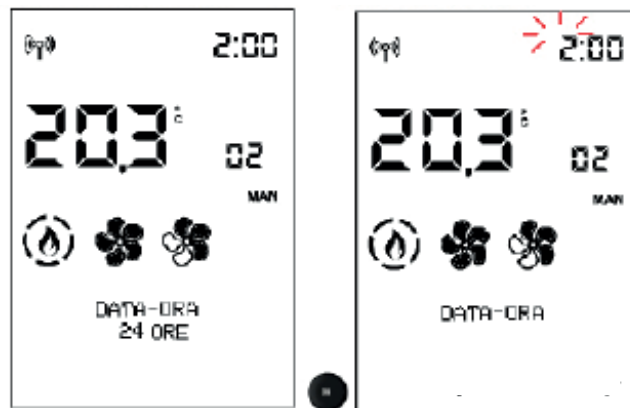
The minutes will then flash



The hours will then flash and can be modified using the  and  buttons, then confirmed with the

 button

The minutes will then flash.





If the product is connected to the cloud, the date and time can be set from the web.

If the product is connected to a smartphone, the date and time can be set using the app.

**LANGUAGE**

Selects the language.



To access the function from the main menu (as indicated in the Menu section above), press the MENU button.

You can scroll the menu items with the  and 

buttons, and enter the item with the  button

After entering the Language Menu item, the name of the function appears on the first line of the status bar and the current value on the second line (ENGLISH)



Modify the language using the  and  buttons then exit and confirm with the  button

Pressing the  button automatically takes you to the first level.

**The following functions must be taken into account only following indications from the technician. Therefore, we do not report the complete explanation in this document.**

**DISPLAY**

Allows you to change the brightness of the display and an acoustic signal when the keys are pressed

**BRIGHTNESS ON**

Indicates the backlight percentage of the display.  
You can switch from one percentage to the other with buttons + and - and confirm with OK button

**STBY BRIGHTNESS**

Indicates the backlight percentage of the display before entering energy saving mode

**TIME ON**

Indicates the time the display remains illuminated

**STANDBY TIME**

Indicates the amount of time the display remains illuminated before entering power saving mode

**BEEP**



Allows to enable an acoustic signal when the buttons are pressed (OFF if deactivated ON if activated)

**INFO**

These readings should only be done when requested by the technician.

The technician understands the diagnostic meaning of the messages and values, and may ask you to read them to him/her if you experience problems.

To access the function from the main menu (as indicated in the Menu section above), press the MENU button.

You can scroll the menu items with the  and  buttons

Pressing the  button automatically takes you to the first level.

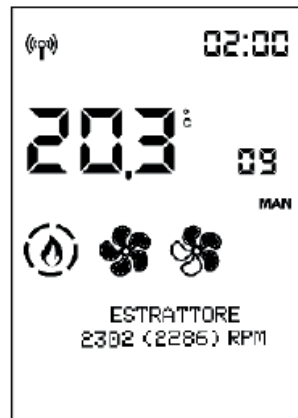
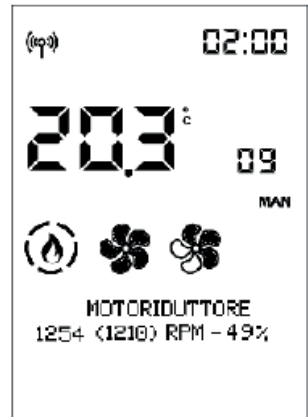
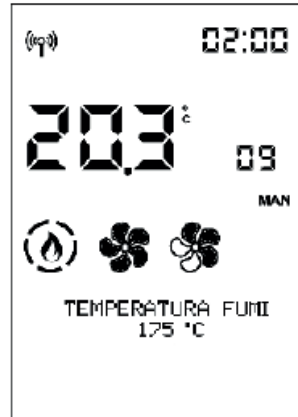

**- INFO (info for INSTALLER continues)**

They provide instant situation values.

**Flue temperature** indicates the value of the temperature read inside the product. To be read only under the guidance of the Technical Assistance Centre

**Auger motor**: indicates the speed set and read. Useful for understanding any anomaly in the motor that loads the pellets. To be read only under the guidance of the Technical Assistance Centre

**Extractor**: indicates the speed set and read. Useful for understanding any anomaly in the engine that creates depression in the combustion chamber. To be read only under the guidance of the Technical Assistance Centre

**Leonardo**: indicates the target value set and read. To be read only under the guidance of the Technical Assistance Centre

**Fan1**: indicates the output voltage. To be read only under the guidance of the Technical Assistance Centre

**Ignition plug (spark plug)**: indicates whether the ignition component is on or off. Useful in the ignition phase to understand functionality.

**Home automation contact**: indicates whether ON or OFF. Useful for understanding functionality.

**Radio signal**: indicates the signal strength in milliwatt decibels. Admissible values from 0 to -95dB

**- SOFTWARE**

Indicates:



- the firmware version of the electronic board (basic board)
- the firmware version of the control panel
- the database (associated by the Technical Assistance Centres with the products)

To be read only under the guidance of the Technical Assistance Centre

**DATA**

Information of the product's operation log can be scrolled with the  and  buttons

To access the function from the main menu (as indicated in the Menu section above), press the MENU button.



You can scroll the menu items with the  and  buttons, and enter the item with the  button



Pressing the  button automatically takes you to the first level.



**ALARMS**

Information of the product's operation log can be scrolled with the  and  buttons.

Readings to be carried out under the guidance of a technician. The meaning of the abbreviations is in the dedicated paragraph  
The alarms are arranged from the most recent to the oldest.



Exit with the button 

**PELLET FALL**

Allows to set the auger motor in continuous cycle or in steps. To be carried out **ONLY UNDER THE GUIDE OF A TECHNICIAN**.

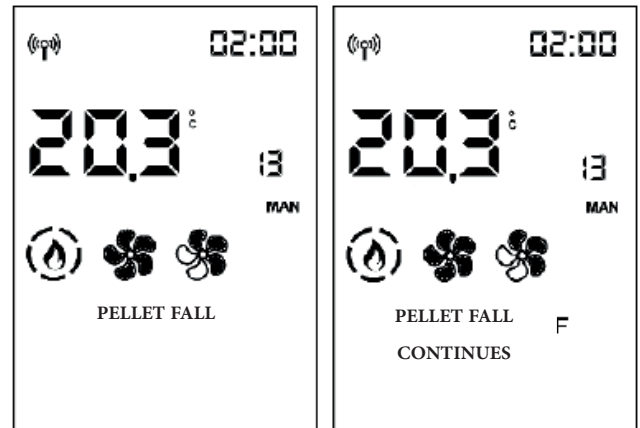

**PELLET SENSOR**

Allows you to set ON or OFF of the pellet level sensor.

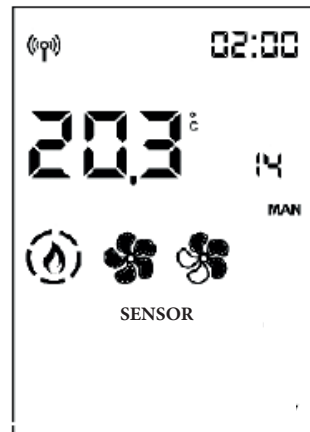

**TECHNICAL MENU (for TECHNICIANS ONLY)**

Accessible only by technicians with password (1111). Once the password has been entered, confirm with the  button

If you enter with the installer password (1111) you will only access the following installer parameters/settings:

- **FLAME TYPE**
- **PELLET TYPE**
- **PARAMETERS**

**- FLAME TYPE (for the TECHNICIAN ONLY)**

In correct installation conditions, with the Service Centre parameters appropriately adjusted, with quality pellets, the intensity of the flame is adjusted:

- STANDARD
- ECO
- PLUS

After entering the Technical Menu, the first item, "FLAME TYPE", will appear



**NOTES**

inappropriate changes can cause the product to seize up

Information on how to use these functions is only available to technicians in the appropriate web area.

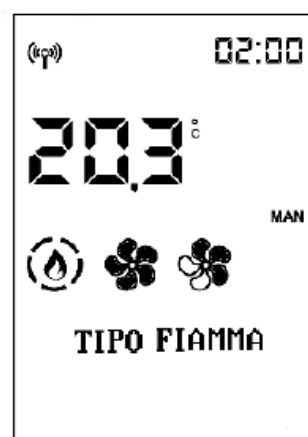





You can enter the Flame Type setting using the  button

while the  and  buttons can be used to modify the correction value.

Pressing the  button automatically takes you to the first level.

**- PELLET TYPE**

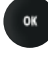
You can scroll the Technical Menu items with the  and  buttons until you reach "PELLET TYPE"

Enter the Pellet Type (%) setting with button  and the value can be modified with button  and 



Use the  button to exit and return to the Technical Menu

In correct installation conditions, with the Service Centre parameters appropriately adjusted, with quality pellets, the pellet load is adjusted

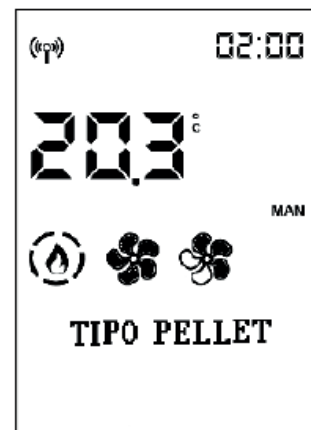
- MEDIUM
- HIGH
- LOW



**- PARAMETERS**

Scroll through the items of the Technician Menu with buttons  and  up to the item "PARAMETERS".

You enter the Parameters with button , the first parameter is displayed.

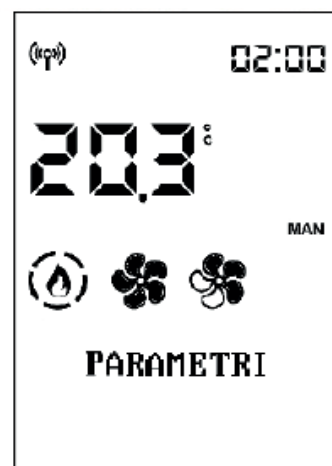

Scroll through the parameters with  and  and the value can be modified with buttons  and .

If you entered the Technician Menu with the Installer Password, only the Installer parameters appear, otherwise all the parameters appear.

**PARAMETERS (continue PARAMETERS for INSTALLER)**

**SENS. PLT LEVEL:** enables or disables the possibility for the end customer to view and choose the status of the pellet reserve indicator

**AIRKARE FUNCTION:** allows to select IF Airkare is active and on which room size (SMALL, less than 30 m<sup>3</sup>, or BIG) or not active (OFF)

**AIRKARE RESET :** allows to reset the working hours of airKare

**DUCTING 2:** allows you to activate the speed of the ducting fan at maximum (ON-OFF)

**DUCTING 3** allows you to activate the speed of the ducting fan at maximum (ON-OFF)

**NUMBER OF FANS:** enables or disables the possibility for the end customer to operate the fan if present.

**ROOM INPUT:** allows to choose which item the end customer reads and adjusts on the Home display. It depends on the type of plant:

- PROBE: room probe, standard in the product
- THERMOSTAT: enables the thermostat, which can be installed in place of the room probe.

**ROOM2/CYL.INPUT:** defines the item to be enabled according to the connected component.

- NO INPUT: default
- PROBE
- THERMOSTAT

**IN. AMB3/CYL/SE:** defines the item to be enabled according to the connected component.

- NO INPUT: default
- PROBE
- THERMOSTAT

**CRONO SYNCHR.:** synchronises the timer

**UNPAIR BLUETOOTH:** enable

**SET TEMPERATURE**

Allows the correction of the reading of some temperature probes. To be carried out ONLY UNDER THE GUIDE OF A TECHNICIAN.

- ADJ ROOM1
- ADJ TEMPRADIO

**SAVE PANEL**

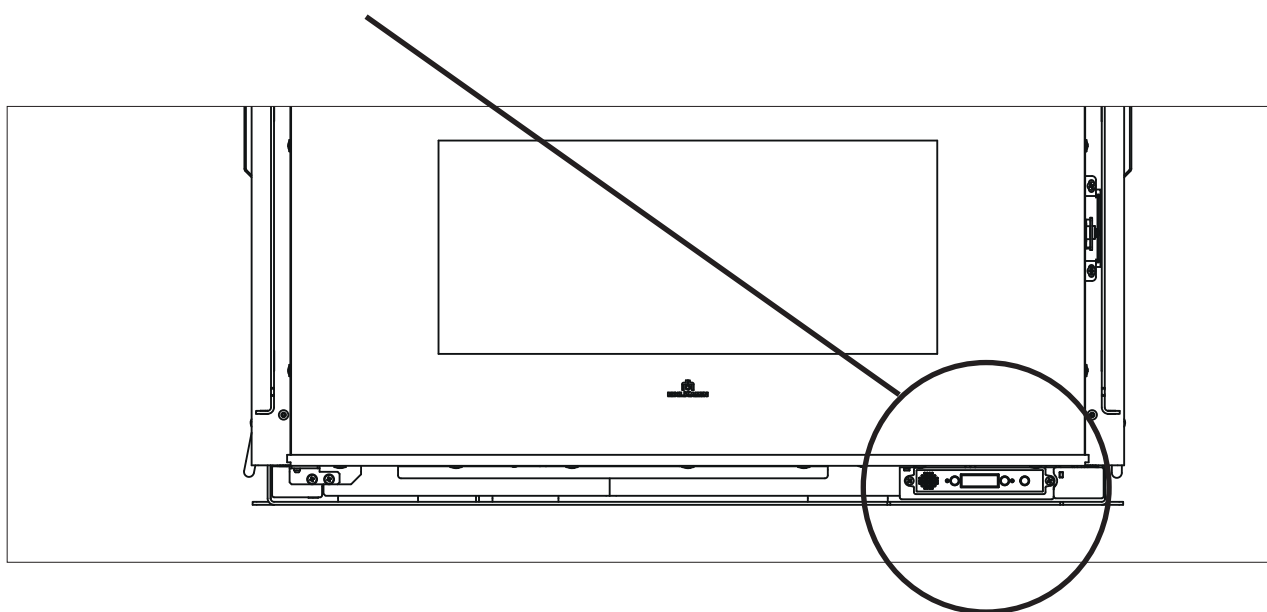

SAVE PANEL can temporarily make up for the absence of a remote control or smartphone, or other product management systems.

Controls the product starting from the pressing of the buttons.

When the remote control or smartphone re-establishes the communication and sends a command to the product, the remote control or smartphone will once again resume control of the product.

The display will ONLY appear if the product is controlled via the SAVE PANEL.

**FUNCTIONS**

**To switch on the product:** press the On-Off button for a few seconds.

**To set the power level with the appliance on:** press the button once

**To switch off the product:** press the On-Off button for a few seconds.

**To unlock the product that has seized due to an alarm:** press the On-Off button for a few seconds.

The table below explains in which conditions the LEDs light up:



Led 1	Presenza di tensione
OFF	Assente
ON	Presente

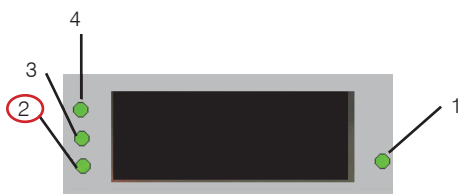

Led 2	Connessione EK Cloud
OFF	Assente
ON	Presente



Led 4	Led 3	Connessione al router WiFi
OFF	OFF	Nessuna
ON	OFF	Scarsa
OFF	ON	Media
ON	ON	Buona



**Before doing any maintenance, disconnect the appliance from the mains.**

**Regular maintenance is essential to keep the appliance in good working order**

**FAILURE TO SERVICE THE PRODUCT may prevent it from working properly.**

**Any problems due to failure to service the stove will void the warranty.**

**N.B.:**

- **Do not make unauthorised modifications**
- **Use original spare parts**
- **Using non-original parts voids the warranty**



**Do not vacuum up hot ash; this damages the vacuum cleaner and may cause a fire.**



**Do not dump the cleaning residue into the pellet tank.**

The only maintenance to be done by the user (described in the following pages) must be done in the combustion chamber **(A)** with the appliance switched off and cold.

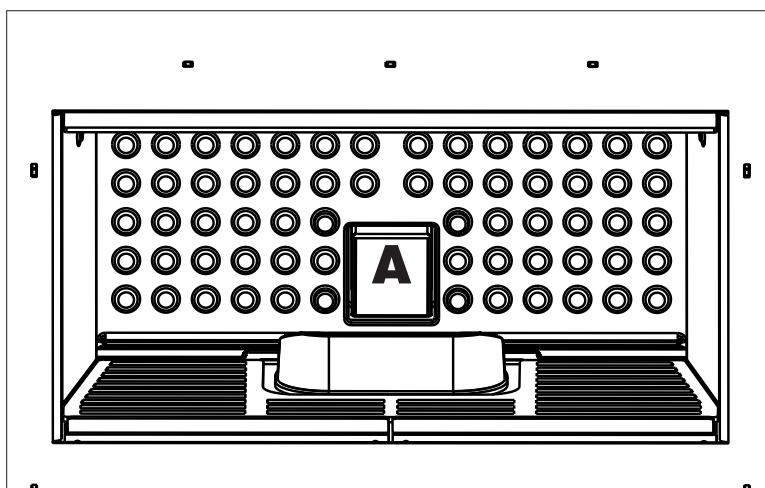

**DAILY MAINTENANCE**

**This must be done with the appliance switched off and cold.**

It must be done with a vacuum cleaner

The entire procedure takes just a few minutes.

- Open the combustion chamber door and remove the burning pot. Remove the grille **(1)**
- Empty the ash tray **(2)** and the burning pot into a non-flammable container (the ashes may still contain embers and/or hot parts).
- Vacuum the interior of the combustion chamber, the bed, and the compartment around the burning pot into which the ash falls.
- Scrape the burning pot and clean out any obstructed holes.
- If necessary, clean the glass (when cold)



**We would remind you that using the stove, without cleaning the burning pot, can cause the gas in the combustion chamber to ignite and lead to detonation**



**PLEASE NOTE: MAKE SURE THAT THE BURNING POT, WHEN FITTED, IS POSITIONED IN ITS SEAT AND THAT THE TOP PART IS WELL POSITIONED WITH THE LOWER PART**

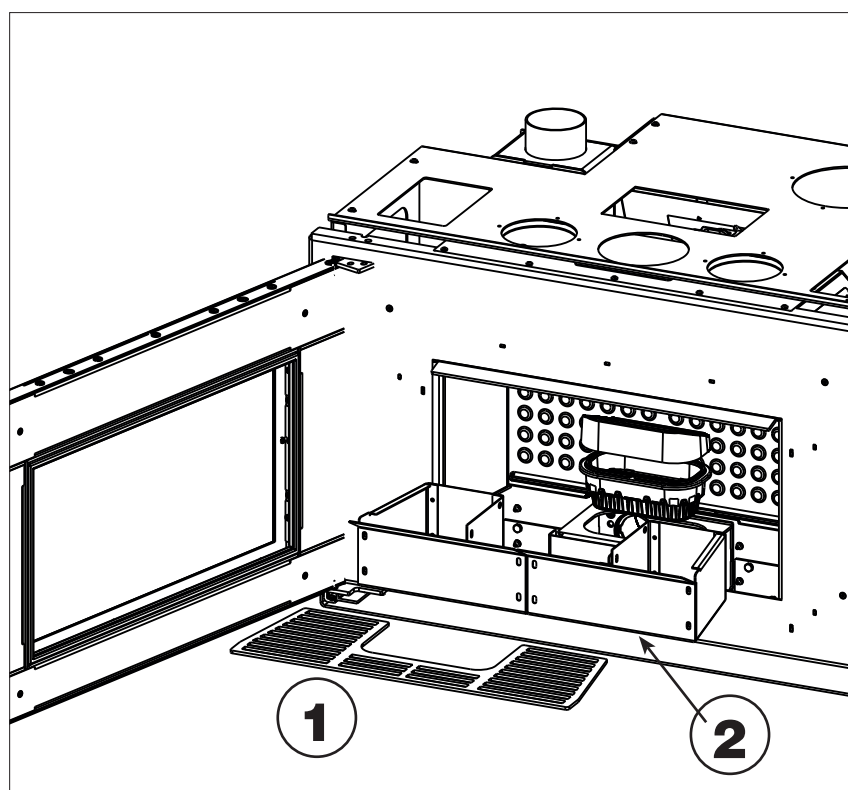

**THE DRAWINGS ARE PURELY INDICATIVE AND DO NOT ALWAYS REFER TO THE SPECIFIC MODEL**

**WEEKLY MAINTENANCE**

Remove the deflectors (**D**) and clean with the vacuum.

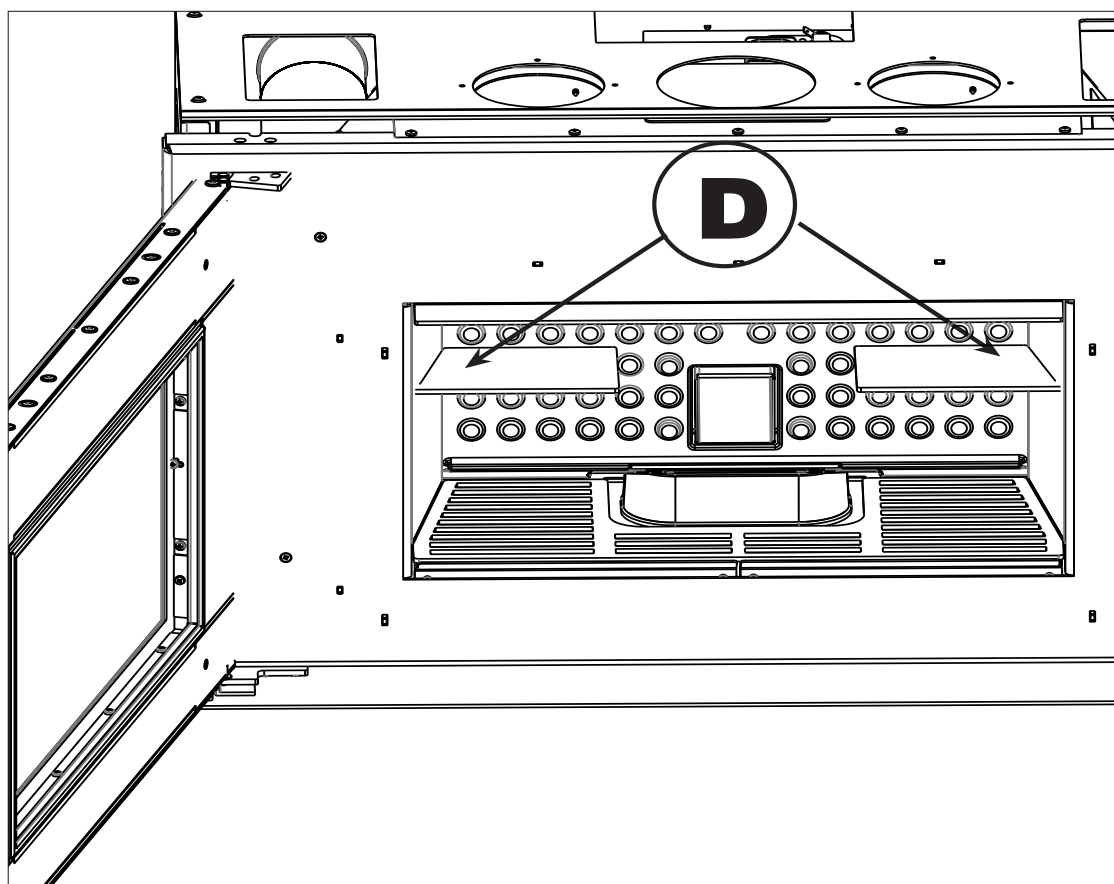
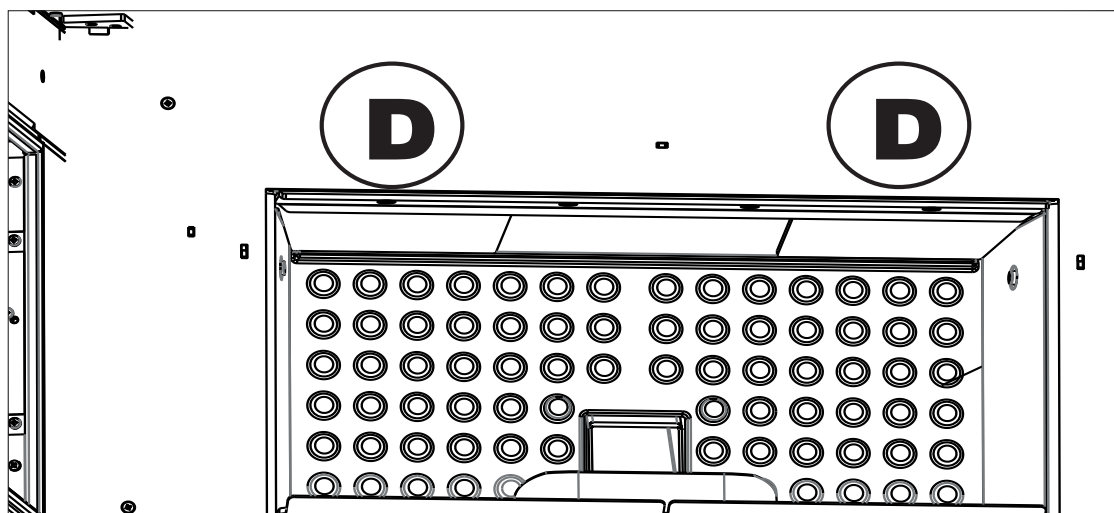

**SEASONAL MAINTENANCE**

**(to be carried out by the technical assistance centre)**

This consists of cleaning the stove inside and out. Seasonal maintenance should be performed by a qualified technician in accordance with the national and local regulations.

**If the product is used intensively, it is recommended to clean the smoke duct and passage every 3 months.**

You should clean the chimney system at least once a year (check local regulations for details).

If you fail to regularly clean and inspect the system, there is an increased risk of the chimney pot catching fire.

**REPAIRS**

To be performed only by Edilkamin technical assistance centres/authorised distributors. The names of Edilkamin official authorised technical assistance centres (TAC) and distributors are available ONLY at [www.edilkamin.com](http://www.edilkamin.com)

**SUMMER SHUTDOWN**

When the product is not used for prolonged periods, keep all its doors, hatches and covers closed.

We recommend emptying out the pellet tank.

Place dehumidifying salts in the combustion chamber.

In particularly humid areas it may be necessary to disconnect the air intake and combustion gas collar.

**SPARE PARTS**

For any spare parts, contact your dealer or technician. The names of Edilkamin official authorised technical assistance centres (TAC) and distributors are available ONLY at [www.edilkamin.com](http://www.edilkamin.com)

Using non-original spare parts may damage the appliance and relieves Edilkamin of all liability for any resulting damages. It also invalidates the warranty on the grounds of tampering.

Do not make any unauthorised modifications.

**DISPOSAL**

At the end of its service life, dispose of the product in accordance with applicable regulations.

The remote control's exhausted batteries must also be disposed of in a regulatory manner.



In accordance with Art. 26 of (Italian) Legislative Decree no. 49 of 14 March 2014, "Implementation of Directive 2012/19/EU on the disposal of electrical and electronic devices (WEEE)".

The crossed-out dustbin symbol displayed on equipment or its packaging indicates that the product at the end of its life must be collected separately from other waste.

At the end of its useful life, the user should therefore deliver the product to a suitable local sorted collection centre for electrical and electronic devices.

Sorted collection for recycling, treatment and environmentally compatible scrapping contributes to the prevention of negative effects on the environment and health, and promotes the re-use and recycling of the materials of which the equipment is made.

In case of an alarm, an alarm code will appear instead of the room temperature.

While the product switches off, the status bar will alternately show "OFF" in large letters and the description of the alarm in small letters.

If the alarm occurred with the timer active, only the timer's activation arrow will remain displayed, while the day's time schedule will disappear.

Once the switch-off sequence terminates, only the alarm description will remain.

If problems occur, the product shuts itself off automatically.

The display will show the reason (see below).

Do not disconnect from the power supply.

To start the appliance again, allow the shutdown procedure to terminate and then press the ON/OFF button  on the remote control or the simplified ignition button.

Before starting the product up again, check the reason for the shutdown and CLEAN the burning pot.

The product is equipped with the necessary safety devices but, if the burning pot is not cleaned regularly as explained above, ignition may involve a slight detonation. If white smoke forms in the combustion chamber for a long time, disconnect the mains supply and wait 30 minutes before opening the door and emptying out the burning pot.

### SHUTDOWN MESSAGES AND THEIR SOLUTIONS:

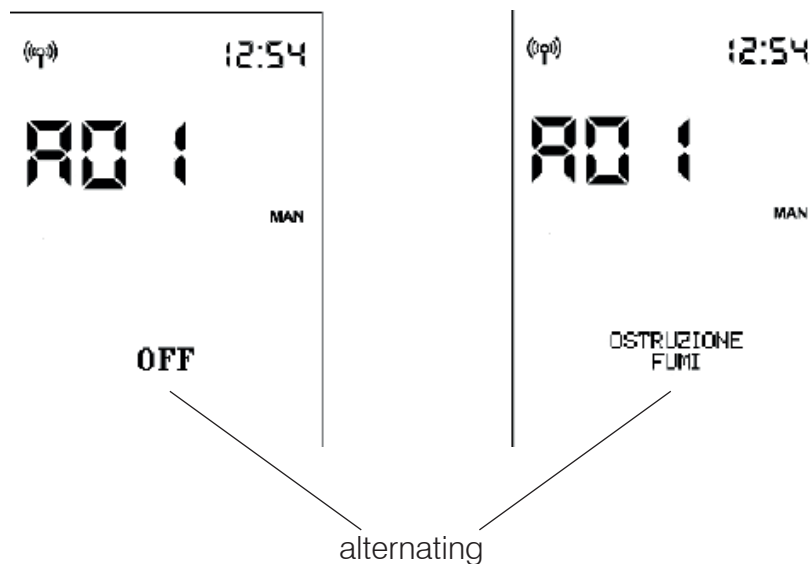

MESSAGE	PROBLEM	SOLUTION
<b>A01</b>	displays when the combustion air intake is below the set level	<ul style="list-style-type: none"> <li>• Check that the combustion chamber door is closed</li> <li>• Check the regular maintenance of the product</li> <li>• Check that smoke discharge and combustion air ducts are clean.</li> </ul>
<b>A02</b>	displays when the logic board is not detecting the right smoke fan speed	<ul style="list-style-type: none"> <li>• Contact the technician</li> </ul>
<b>A03</b>	displays when the thermocouple detects a smoke temperature lower than the set value and interprets this as the absence of flame	<ul style="list-style-type: none"> <li>• Check that there are pellets in the tank</li> <li>• Contact the technician</li> </ul>
<b>A04</b>	displays when ignition times out unsuccessfully	<p>There are two possibilities: NO flame:</p> <ul style="list-style-type: none"> <li>• Check that the burning pot is seated properly and clean</li> <li>• Check that there are pellets in the tank and burning pot</li> <li>• Try switching it on with a solid ecological igniter (contact the technician beforehand and follow the instructions of the igniter supplier very carefully).</li> </ul> <p>The operation must be regarded purely as a trial under the technician's guidance.</p>
<b>A05</b>	Shutdown due to air flow rate sensor breakage	<ul style="list-style-type: none"> <li>• Contact the technician</li> </ul>
<b>A06</b>	displays when the logic board determines that the fumes thermocouple is broken or disconnected	<ul style="list-style-type: none"> <li>• Contact the technician</li> </ul>
<b>A07</b>	Shutdown due to exceeding of the maximum smoke temperature.	<ul style="list-style-type: none"> <li>• Check the type of pellet (contact the technician if in doubt)</li> <li>• contact the technician</li> </ul>
<b>A08</b>	Switching OFF due to excessive overheating of the product	<ul style="list-style-type: none"> <li>• see A07</li> </ul>
<b>A09</b>	Shutdown due to gearmotor failure.	<ul style="list-style-type: none"> <li>• Contact the technician</li> </ul>
<b>A10</b>	Switching OFF due to circuit board overheating.	<ul style="list-style-type: none"> <li>• Contact the technician</li> </ul>
<b>A11</b>	Switching OFF due to the intervention of the safety pressure switch.	<ul style="list-style-type: none"> <li>• Ensure the product and flue are clean</li> <li>• Contact the technician</li> </ul>

MESSAGE	PROBLEM	SOLUTION
<b>A12</b>	Room temperature probe failure. The product is operating in manual mode.	<ul style="list-style-type: none"><li>• Contact the technician</li></ul>
<b>A13</b>	Ducting room temperature probe (if present) fault. The product is operating in manual mode.	<ul style="list-style-type: none"><li>• Contact the technician</li></ul>
<b>A14</b>	Ducting room temperature probe (if present) fault. The product is operating in manual mode.	<ul style="list-style-type: none"><li>• Contact the technician</li></ul>
<b>A20</b>	Gearmotor TRIAC fault switch-off	<ul style="list-style-type: none"><li>• Contact the technician</li></ul>

**MESSAGES WHICH DO NOT SHUT THE STOVE DOWN, BUT ARE SIMPLY WARNINGS****LOW REMOTE CONTROL BATTERY LEVEL:**

The battery symbol displays on the remote control display if the battery is low.

**MAINTENANCE:**

A spanner symbol will appear on the display after 2,000 hours of operation.

The product is working, but it must be serviced by an authorised Edilkamin technician.

**LACK OF COMMUNICATION:**

In case of a prolonged lack of communication between the product and the remote control, the Bluetooth transmission icon ((p)) will disappear as well as the icons transmitted by the circuit board to the remote control. Only the room temperature and the time will remain visible.



The Wi-Fi transmission icon  will only appear if there is a connection between the circuit board and the Wi-Fi router.



**PELLET RESERVE INDICATOR:**

The function is only available if the pellet level sensor is installed and has been activated.

When the level sensor intervenes, the circuit board emits a single "beep" (in any switch-on or work status) and the moving reserve symbol will appear on the display.

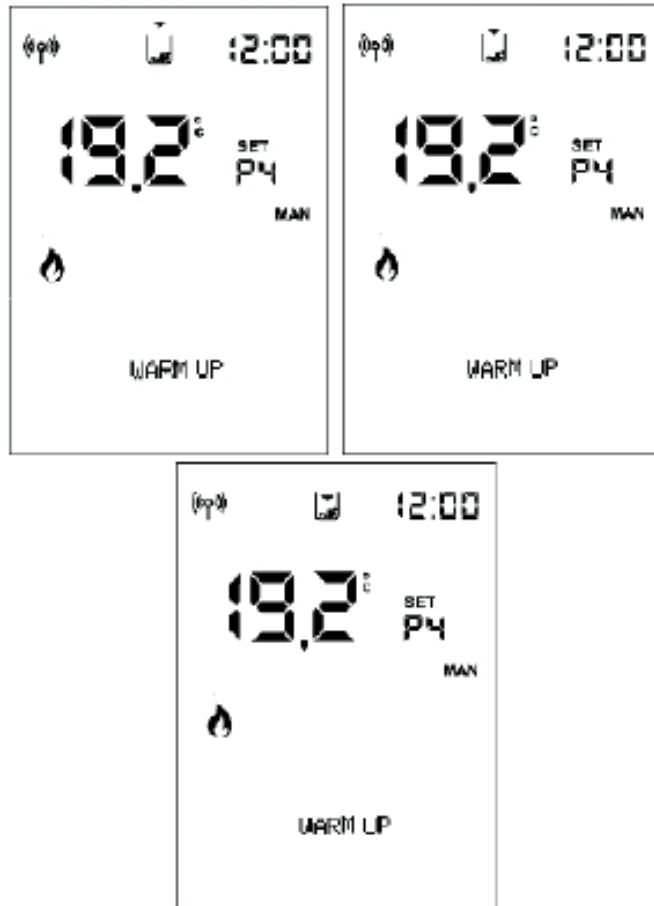

The arrows will light up in sequence to signal the need for pellet loading.



The ignition frequency is roughly 0.5 seconds.

After an interval of roughly 20/30 minutes, which varies depending on the model, the product switches off due to shortage of pellets.

If the user refills the product before the start of the switch-off procedure, the symbol disappears and the stove resumes its normal operation.

If the user fails to refill the product before the start of the switch-off procedure, the product switches off and the tank symbol remains steady lit with the 3 arrows on until the next refilling operation.

When the reserve symbol appears, the product cannot be restarted.

After reloading the pellets, the stove must be restarted manually.

If the pellets are reloaded and there is an ignition request coming from the timer, the product will restart.

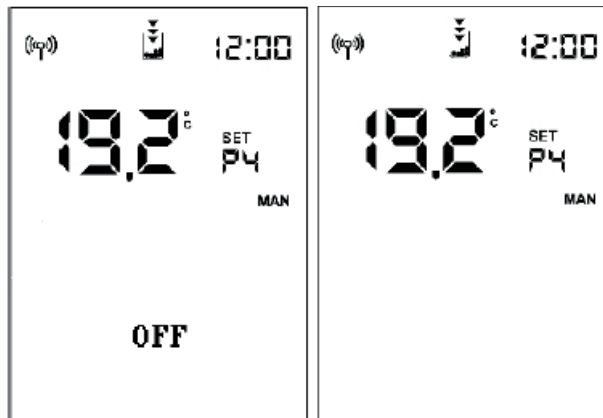

If the sensor intervenes:

- with the product OFF or in Initial Cleaning mode (following manual emptying of the tank), the final symbol will immediately appear and the stove cannot be switched on;
- during the ignition phase, the ignition sequence will be completed even if it lasts more than the 20/30 minutes of residual autonomy.

If the pellets are not reloaded, the stove will then switch off.

During a switch-off following a **BLACKOUT**, the display will alternately show the words “Black-Out” and “OFF”. Once the switch-off has been completed, the product will remain off and “Black-Out” will appear.

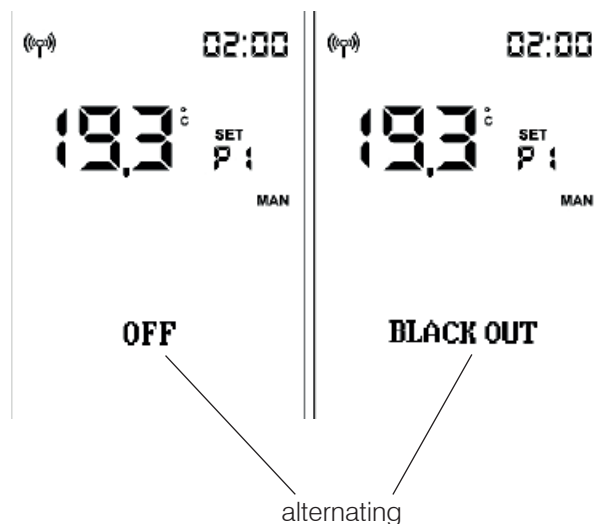

The names of Edilkamin official, authorised technical assistance centres (TAC) and distributors are available ONLY at [www.edilkamin.com](http://www.edilkamin.com)



[www.edilkamin.com](http://www.edilkamin.com)

code 942239-GB 07.22/B